

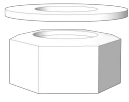

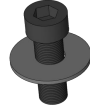



ADA installation instructions.

FRÍANT

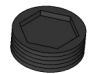
PARTS LIST

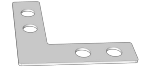
NO.1		The connection between bottom ends of all vertical keels and ground rail B.	NO.6		Use 1: Adjust ground track B to level. Use 2: Connect ceiling module and ceiling frame. Use 3: Connect ceiling modules and light troughs.
NO.2		The connection between the upper end of all vertical keels and the ceiling frame.	NO.7		Adjust ground track B to level.
NO.3		Fixed accessories No. 4 and No. 5.	NO.8		The connection between hinge and door jamb or the connection between hinge and door.
NO.4		Connections at the corner of the ground rail A.			
NO.5		Connection at the corner of ground rail B.			



Please read this manual carefully and check all parts before assembly!
Please be careful during assembly to prevent injury or damage to the product!

1、Install floor rails.

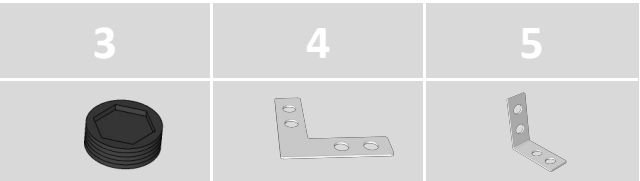
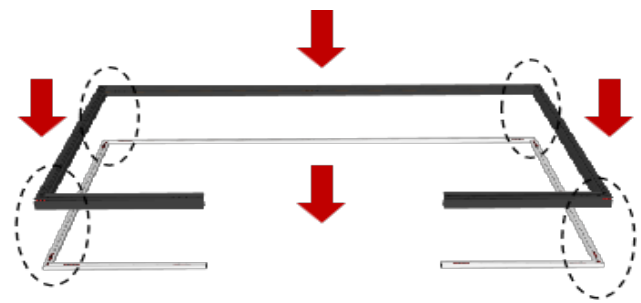
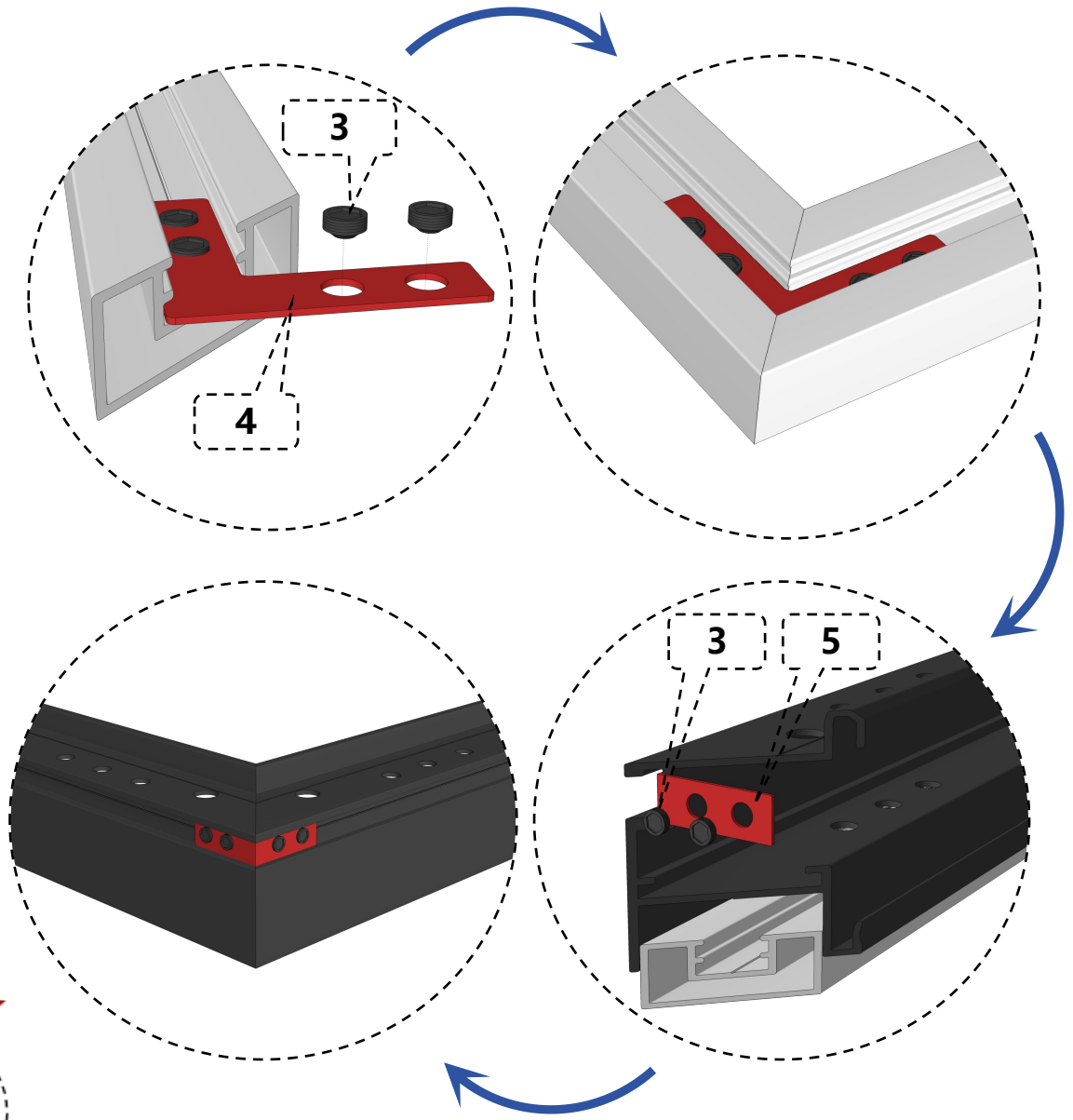
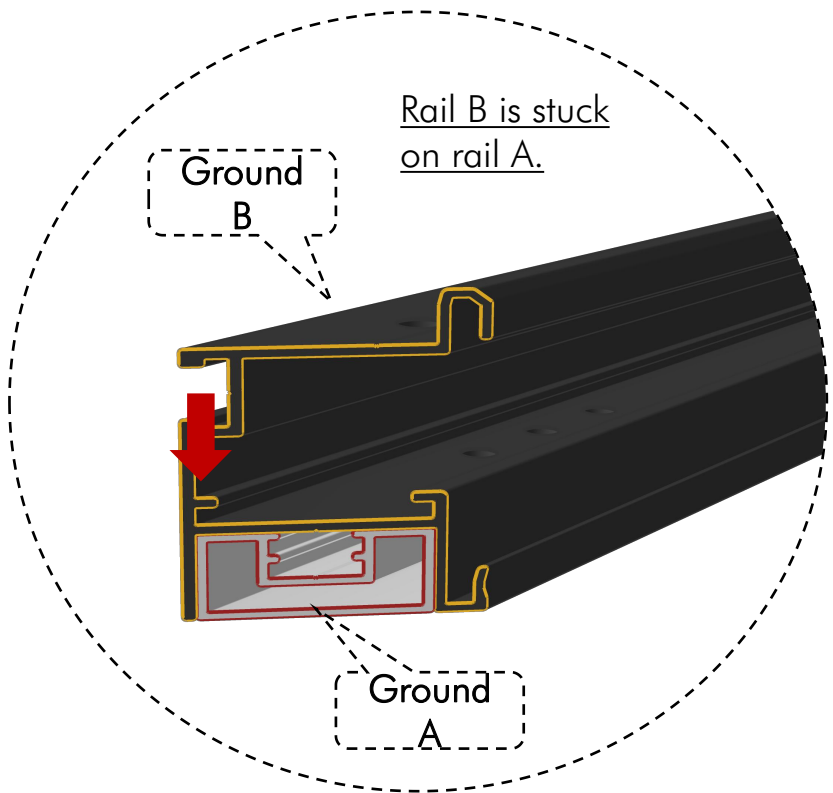

2、Adjustment level.

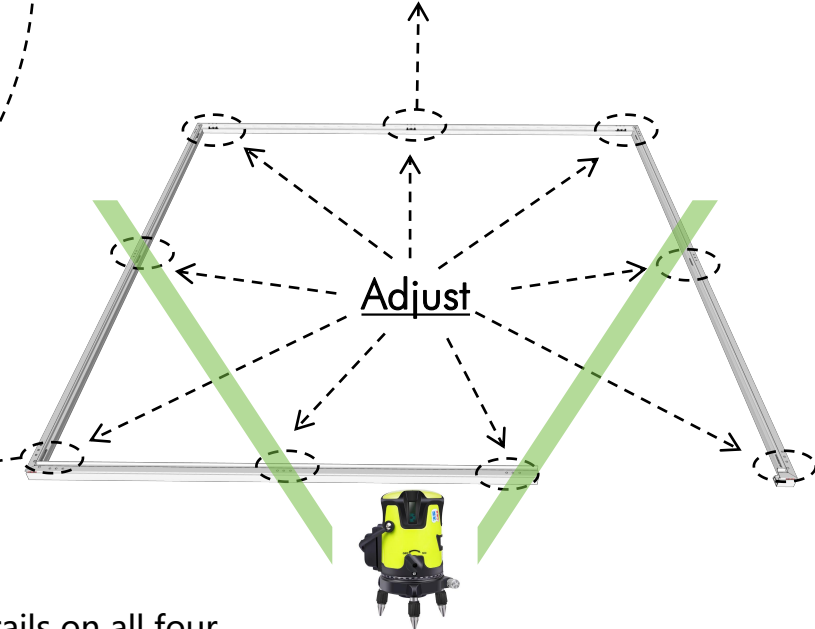
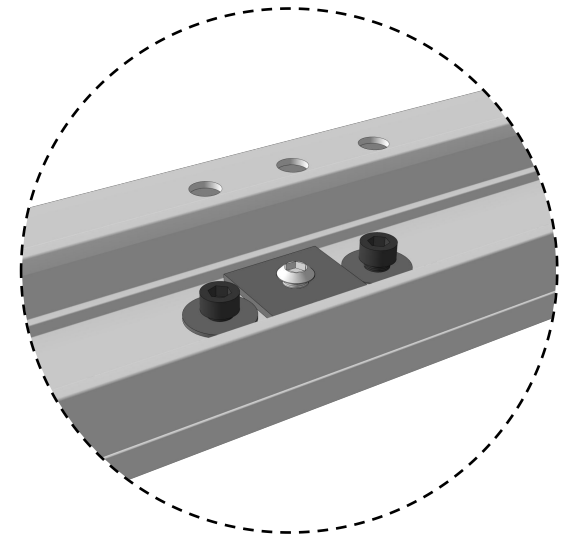
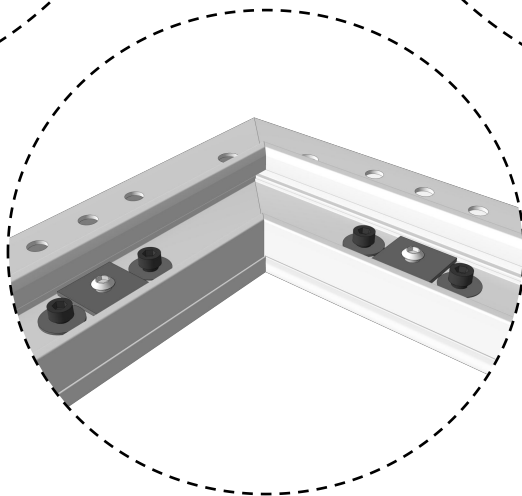
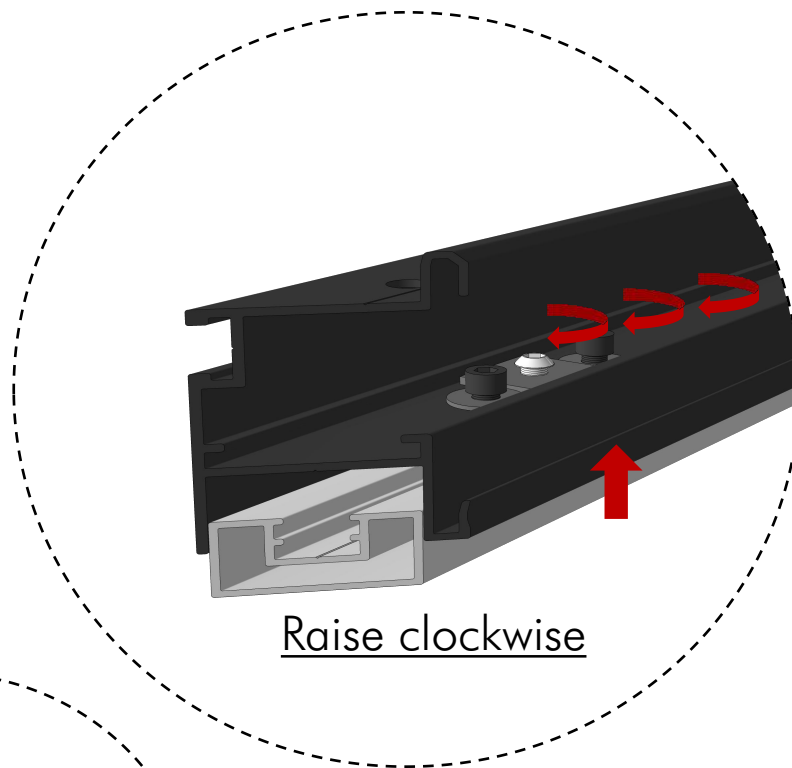
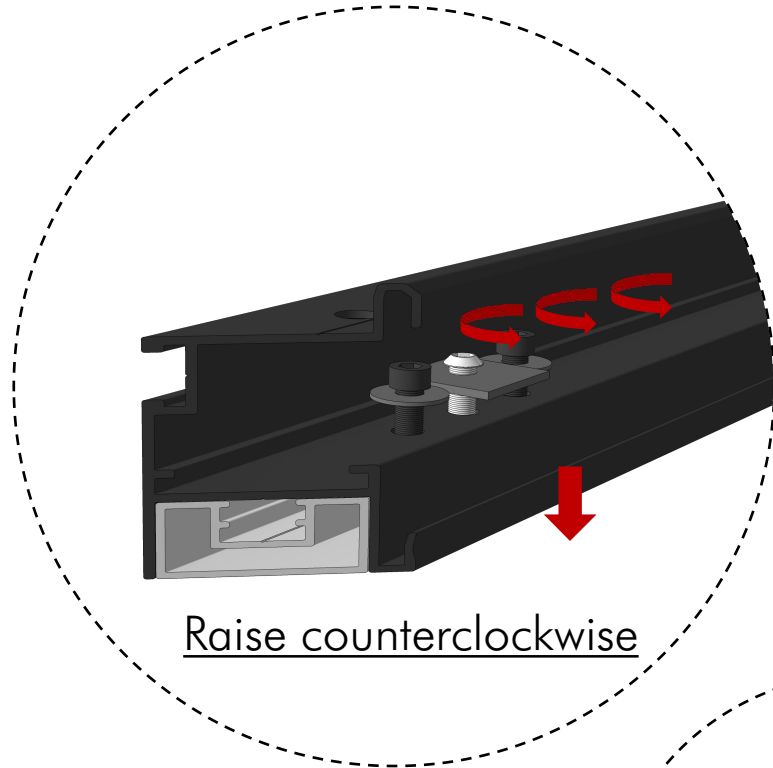

* Adjust the height of the ground rails on all four sides to be consistent according to the on-site ground conditions.

6



7



3、 Install curved keel columns.

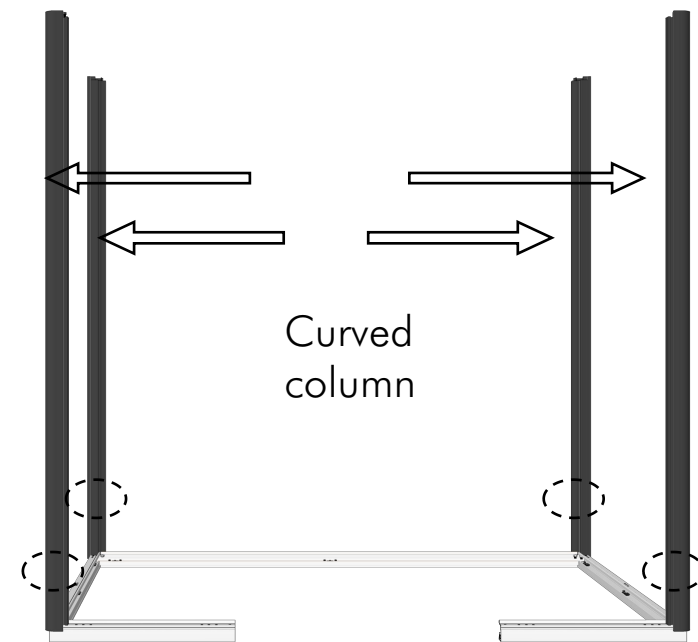
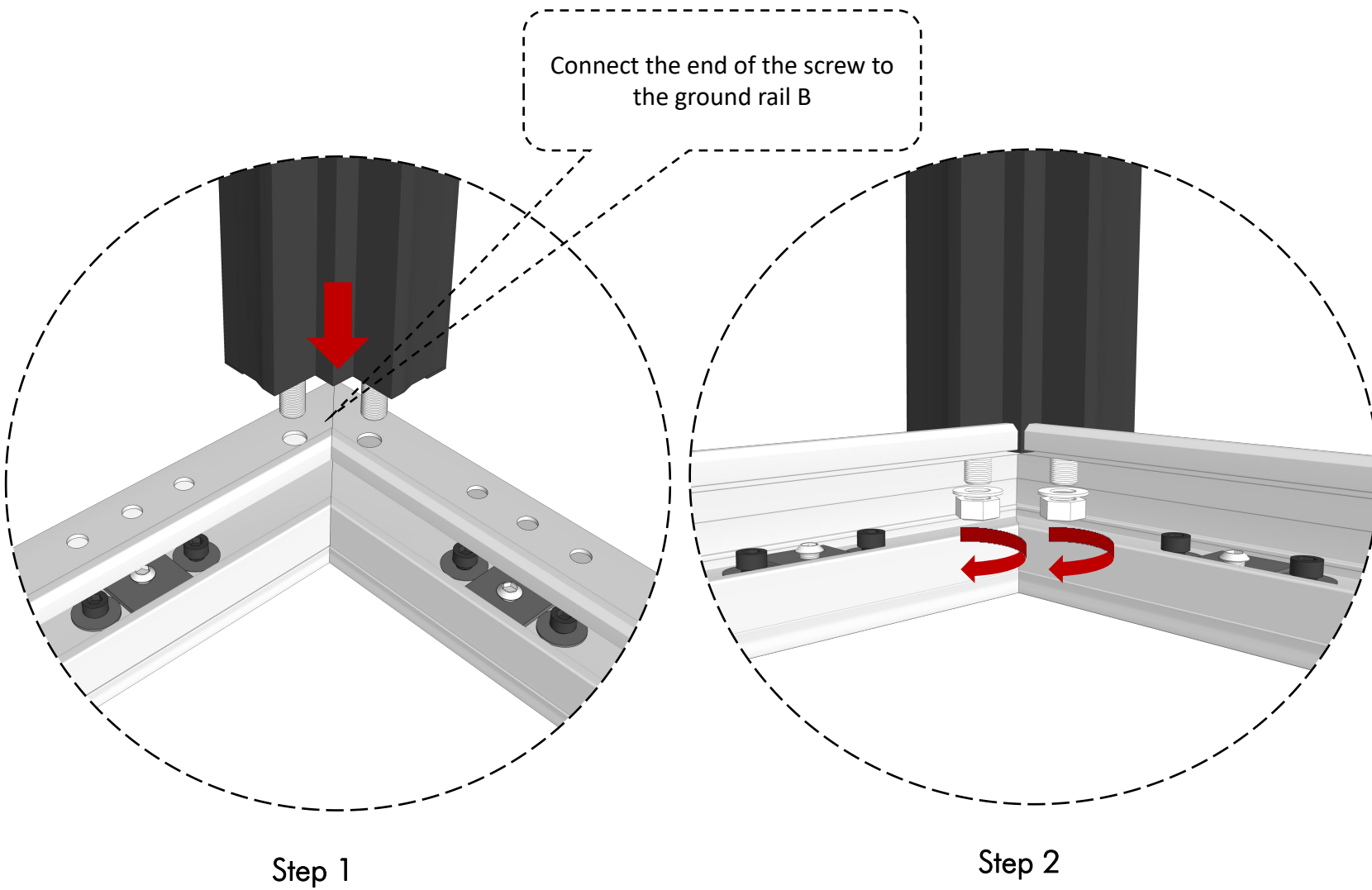



1

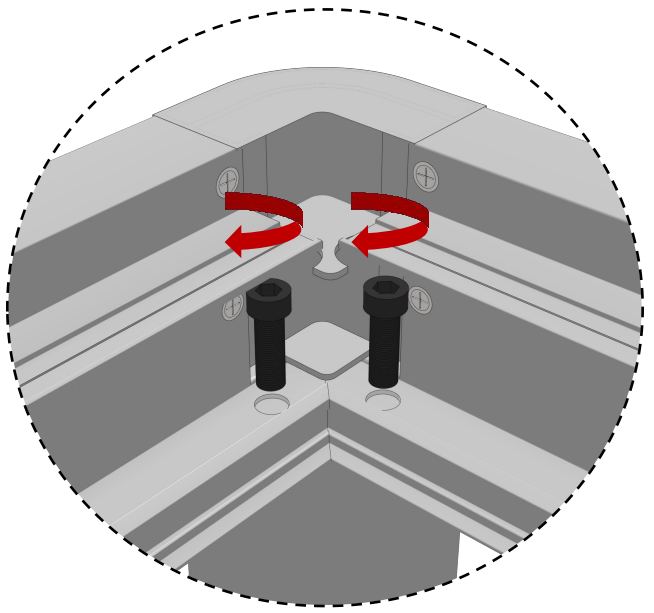
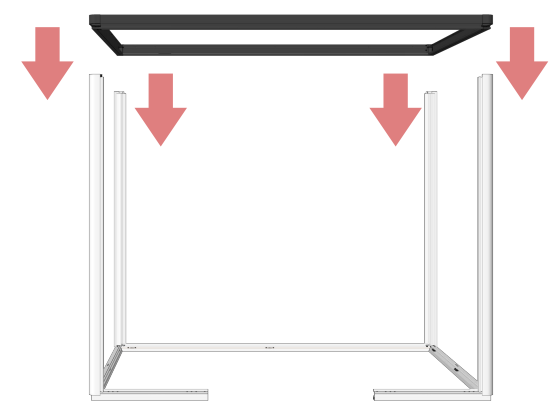
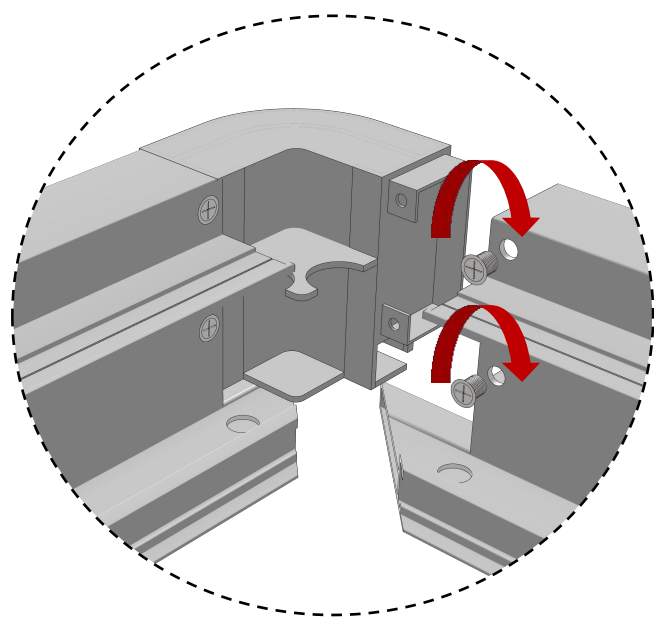
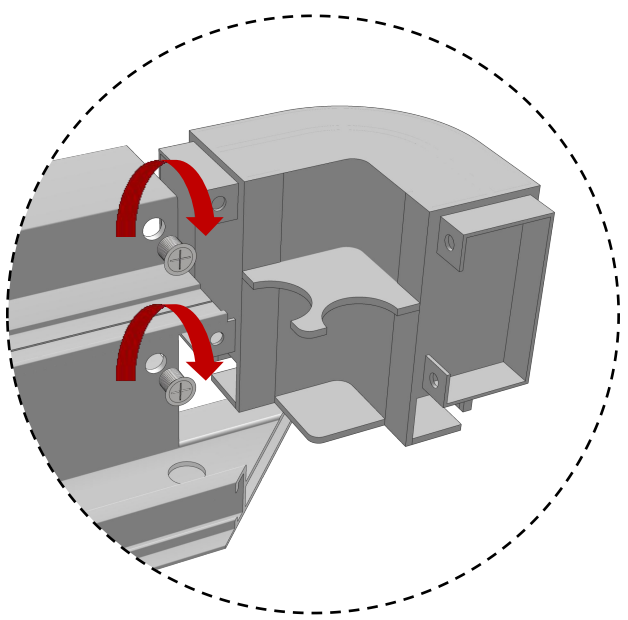
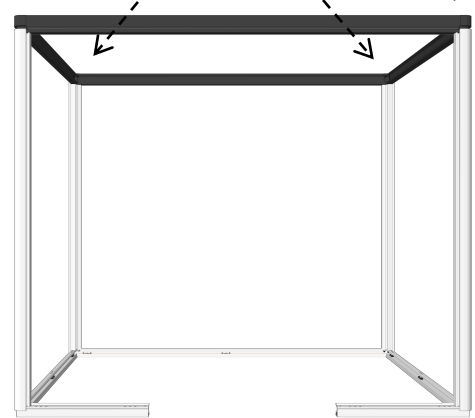
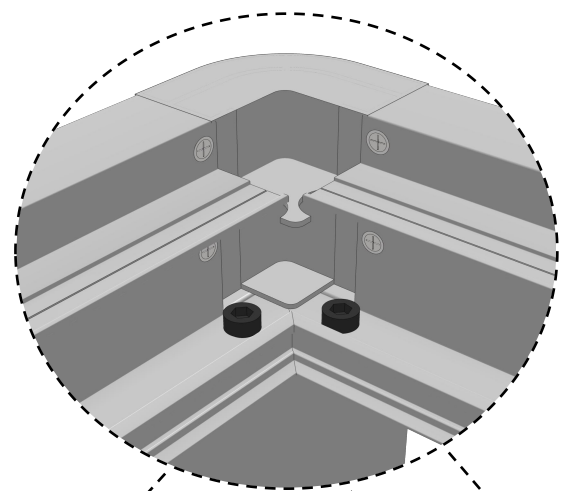

4、 Install ceiling frame.



2	8
	

5、 Install steel plate keel.

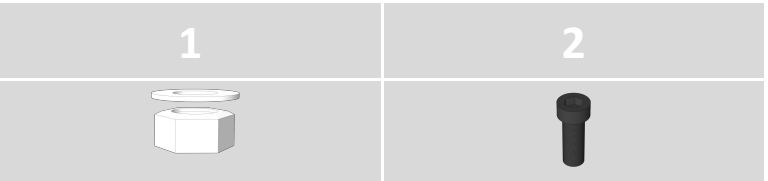
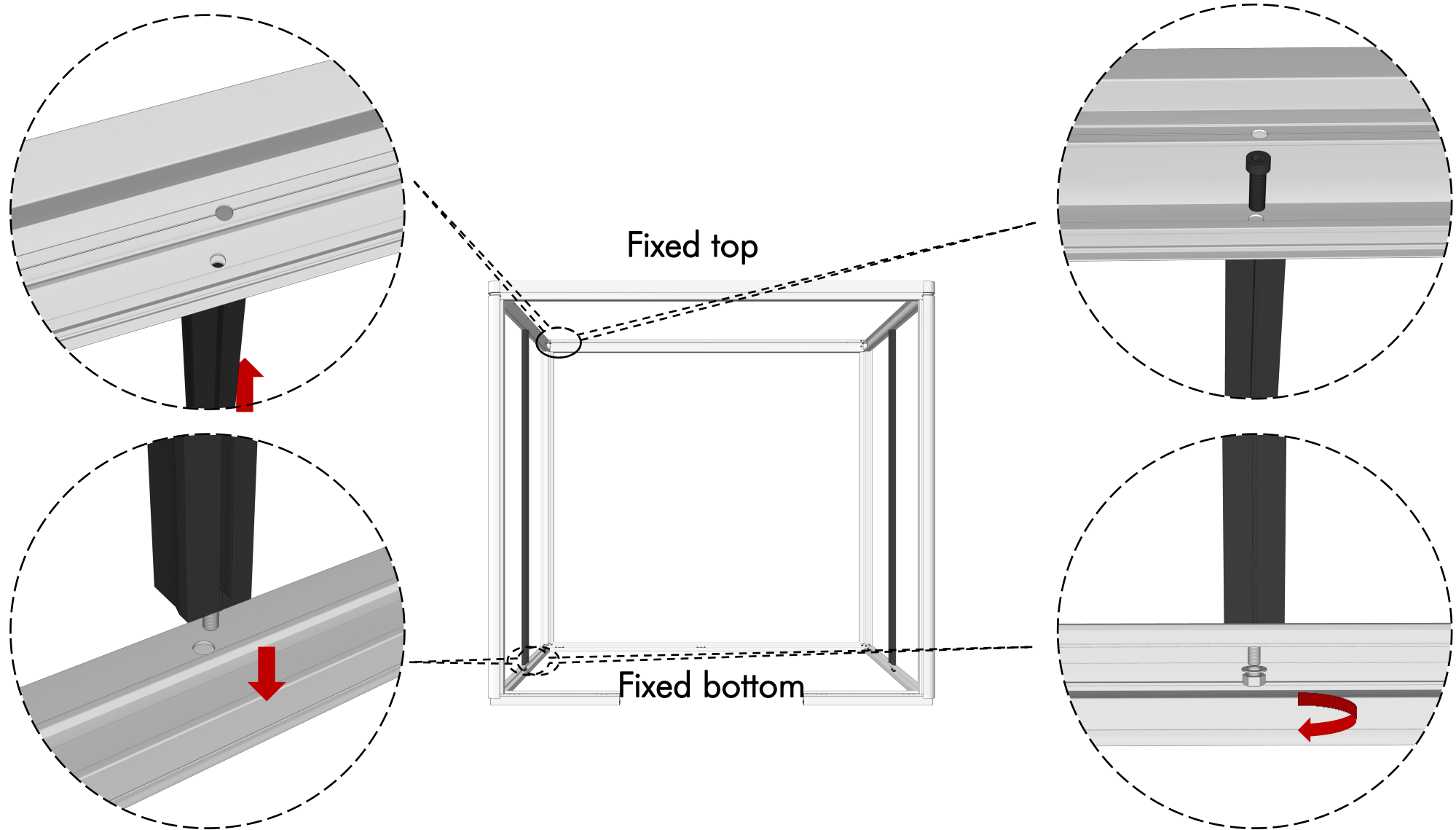

6、 Install steel plate module.

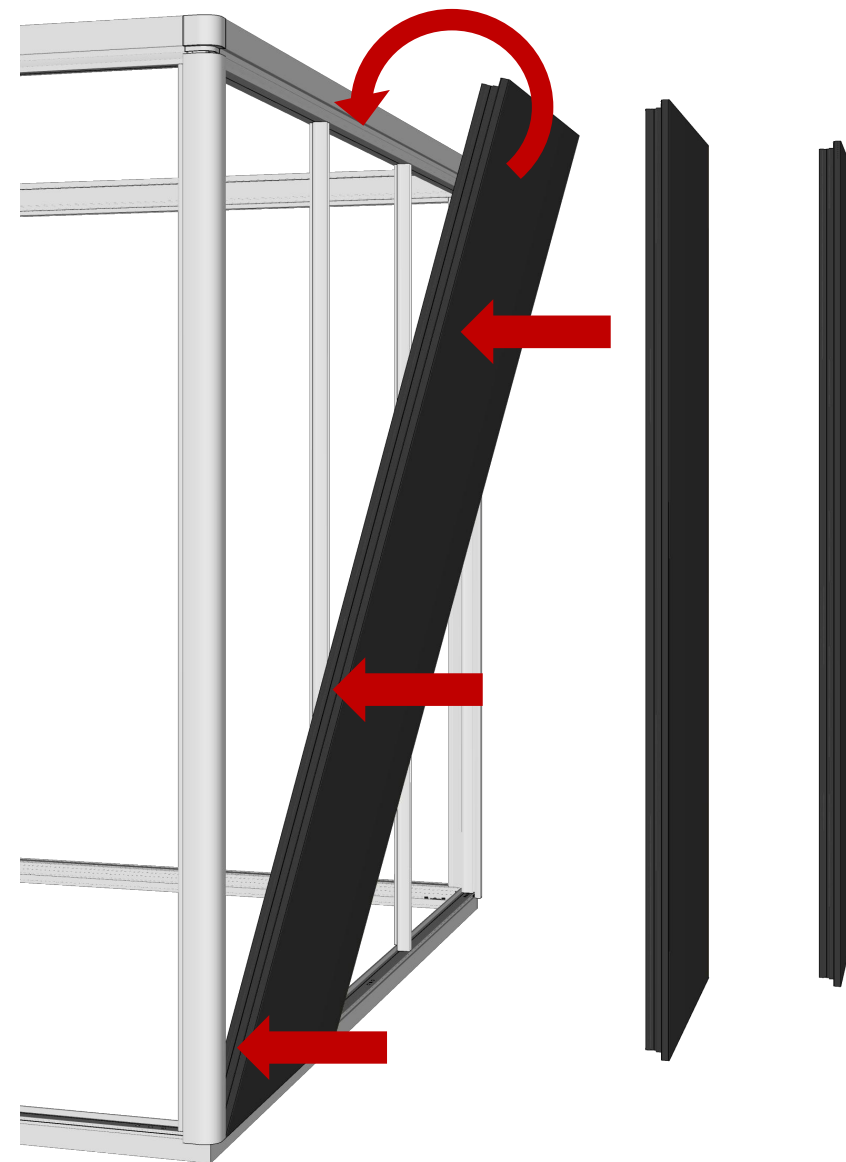
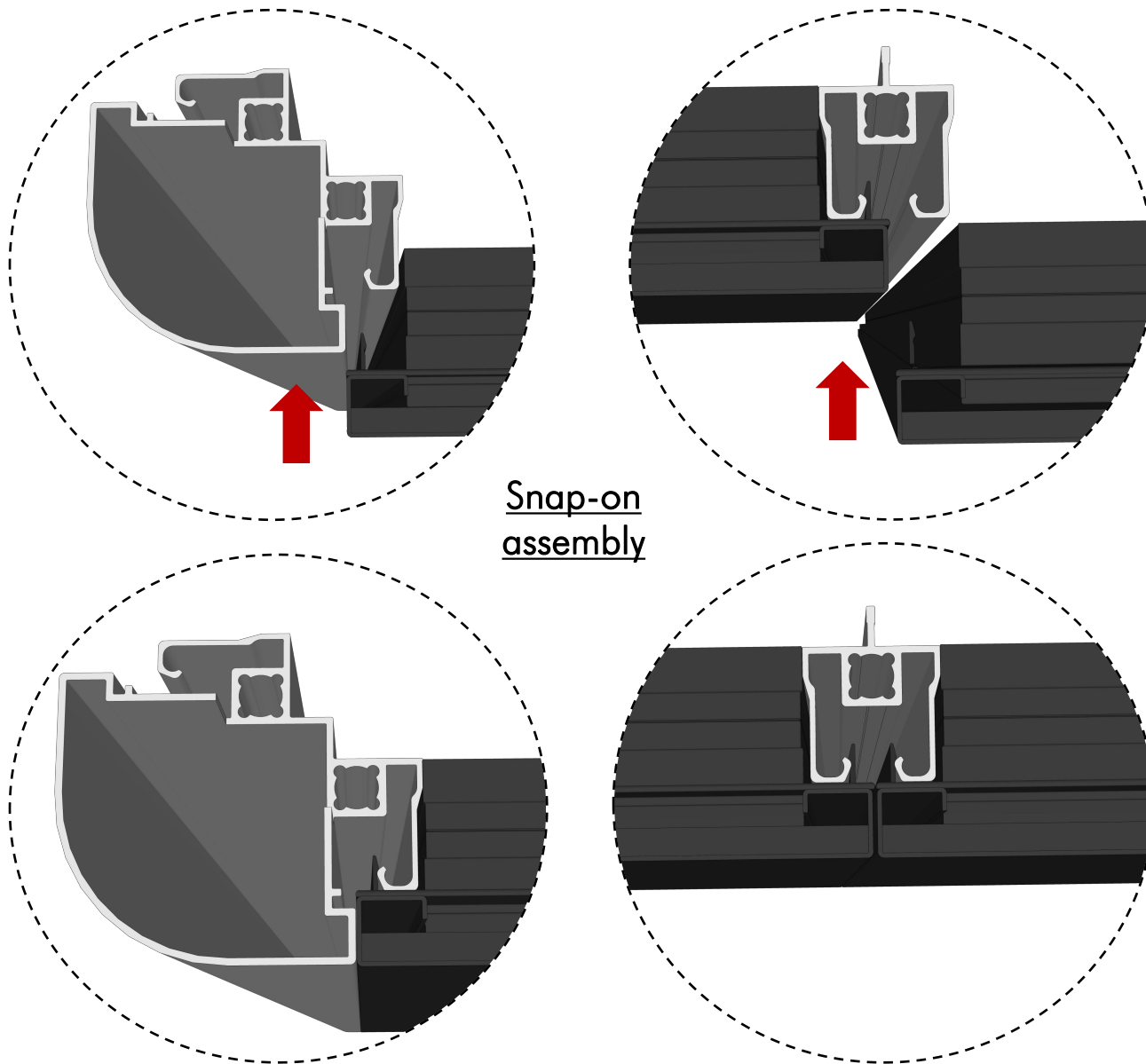

7、 Install door frame keel.

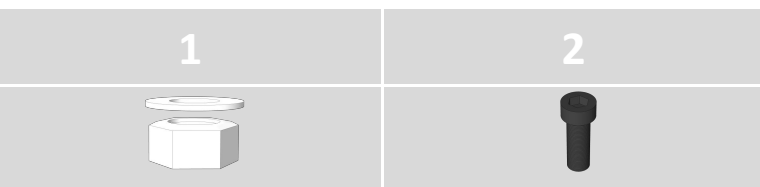
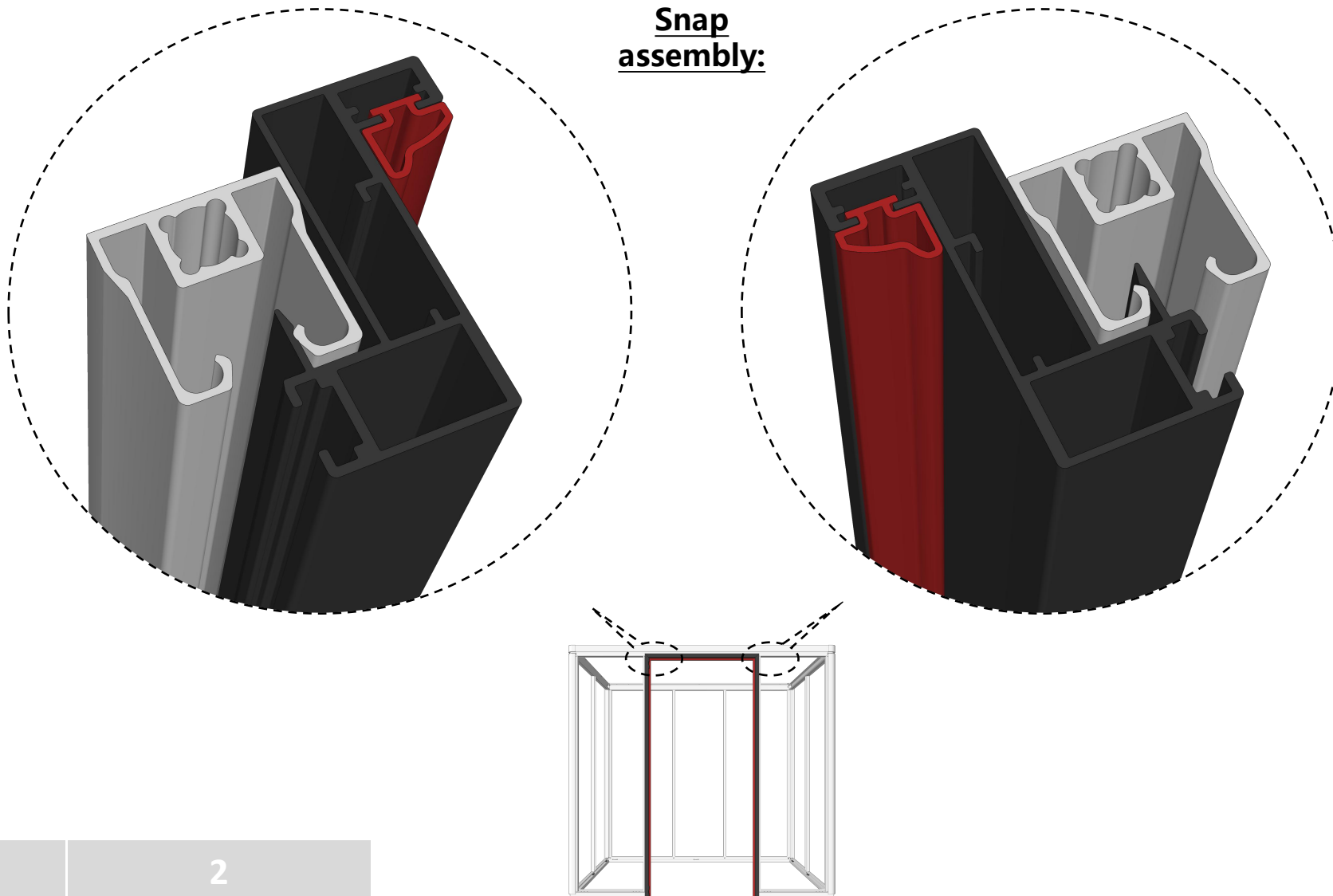

8、 Install door Jamb.

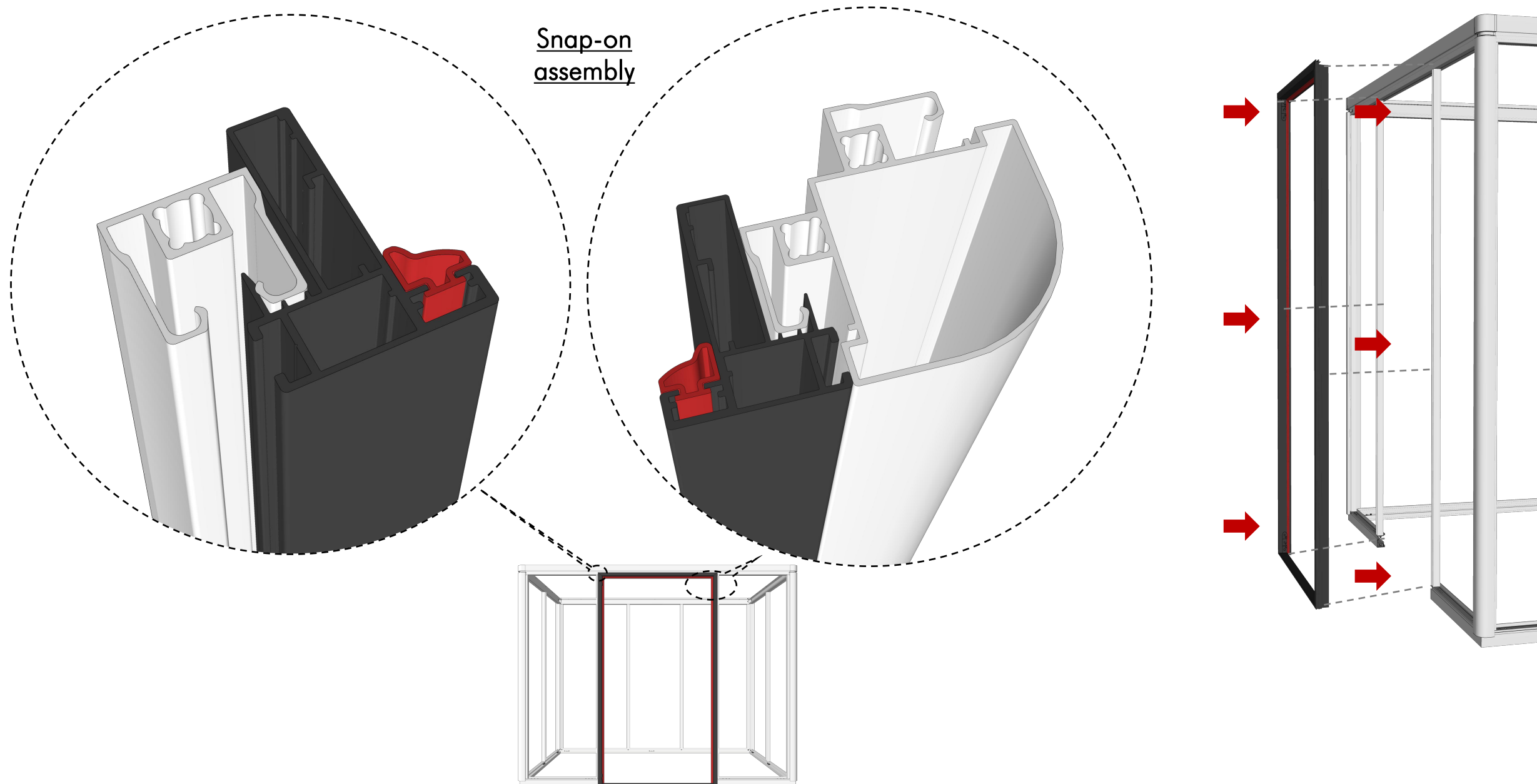

9、 Install glass frame.

*Check whether the glass frame has glass frame adhesive strips, without contacting the salesperson.

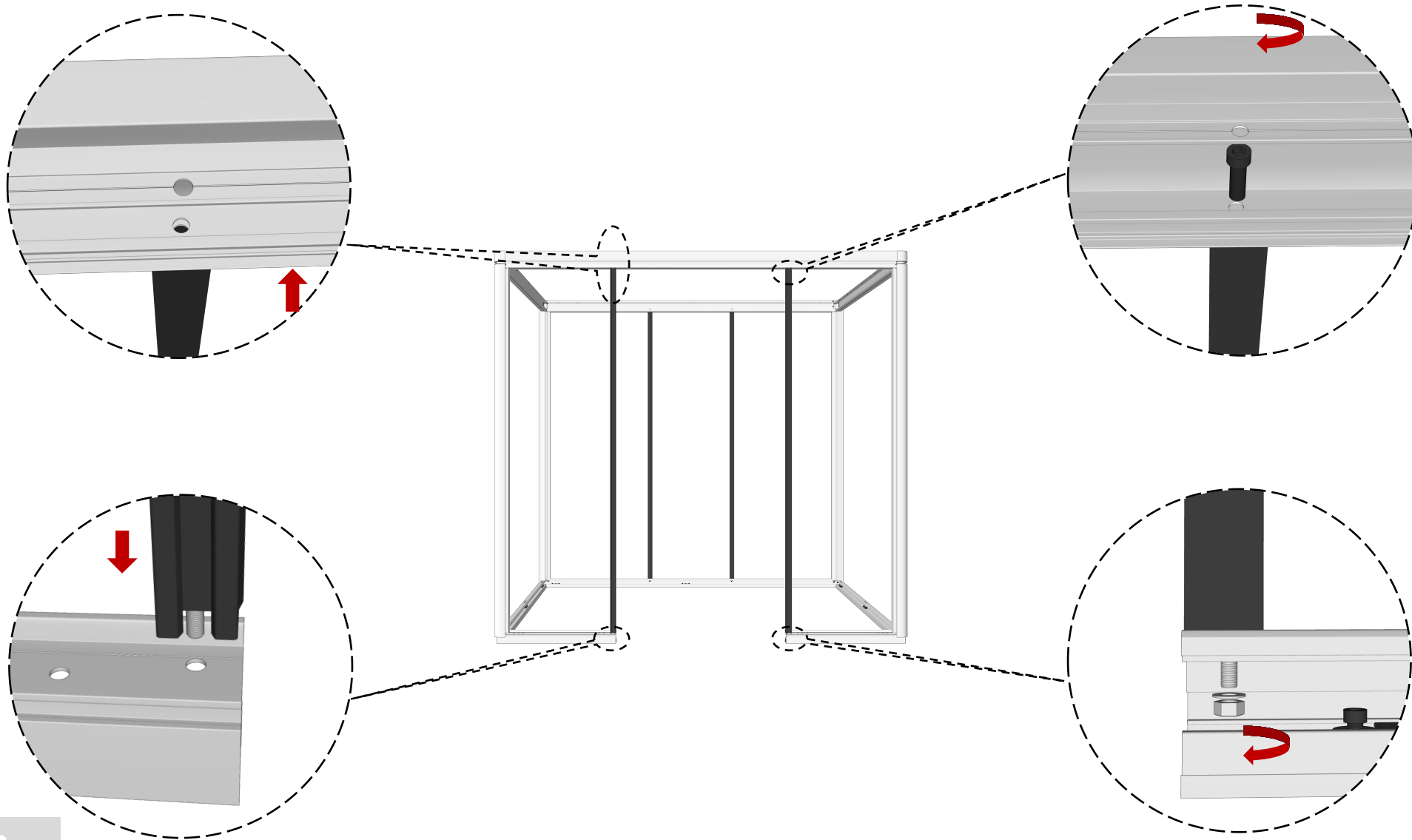

1



2



10、 Install glass panle .

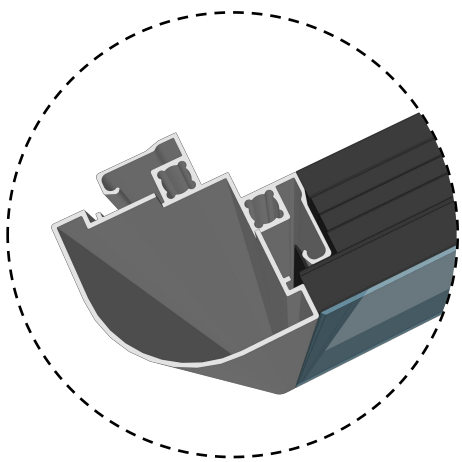

Snap-on
assembly

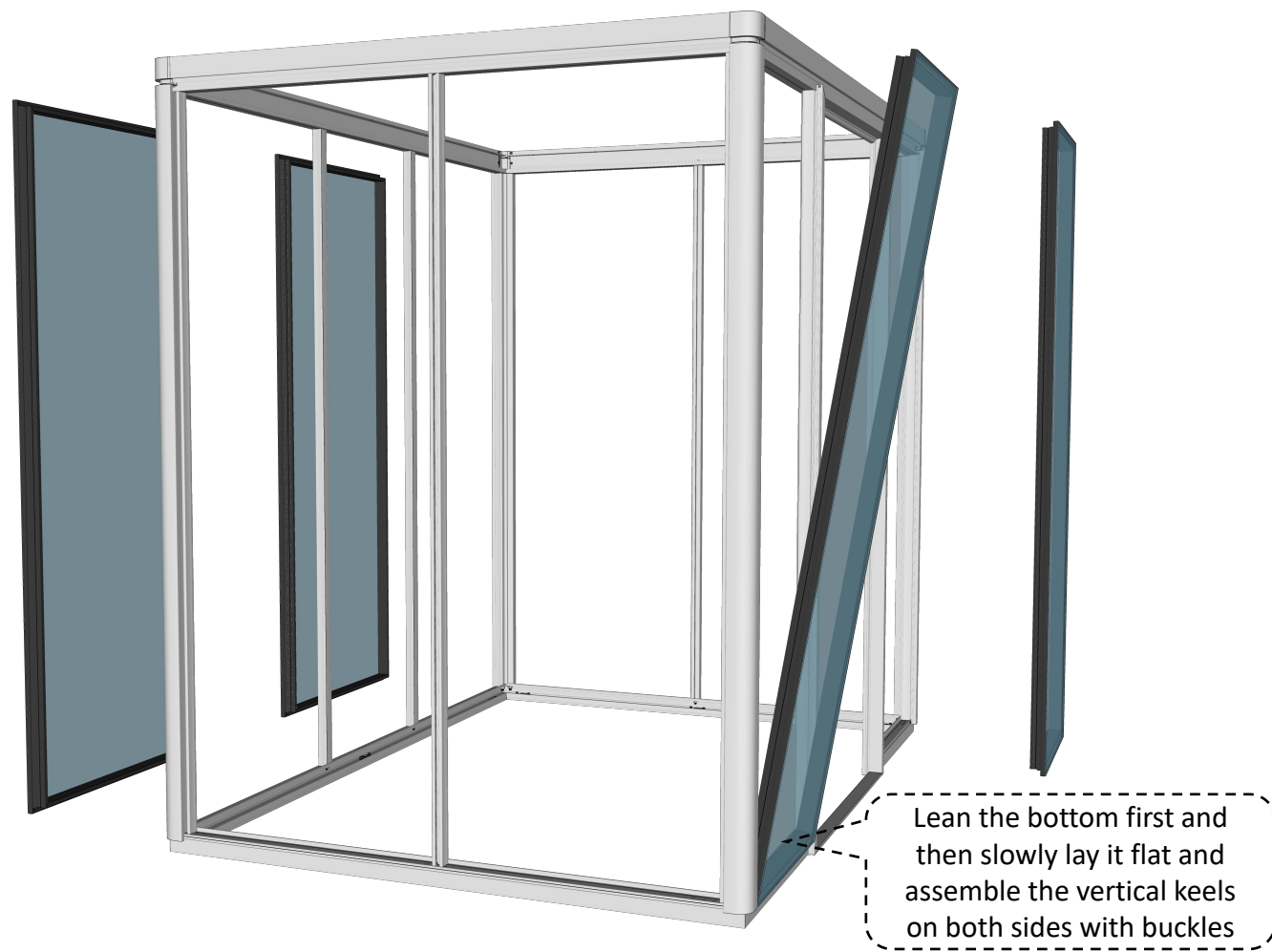
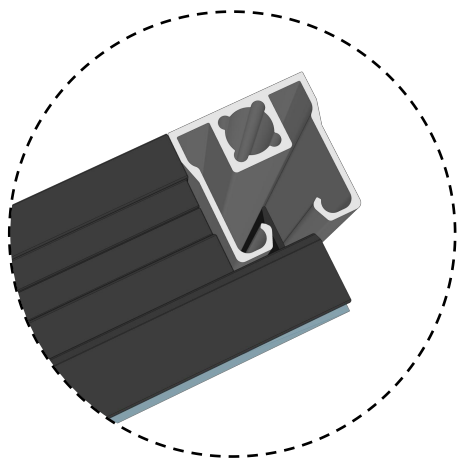

11、Install ceiling modules and light troughs .



step 1

step 2

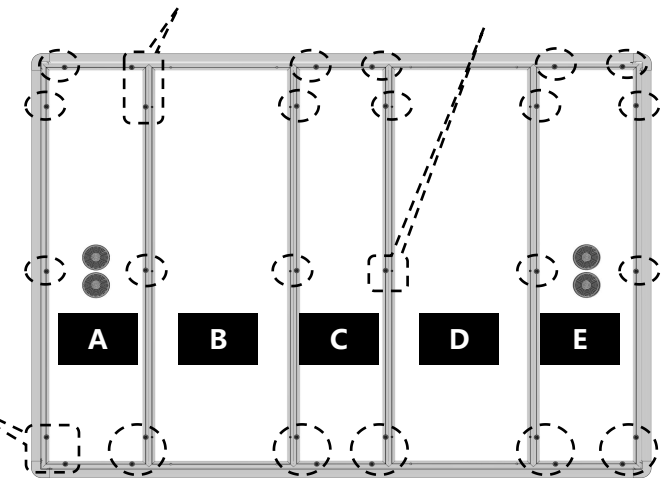
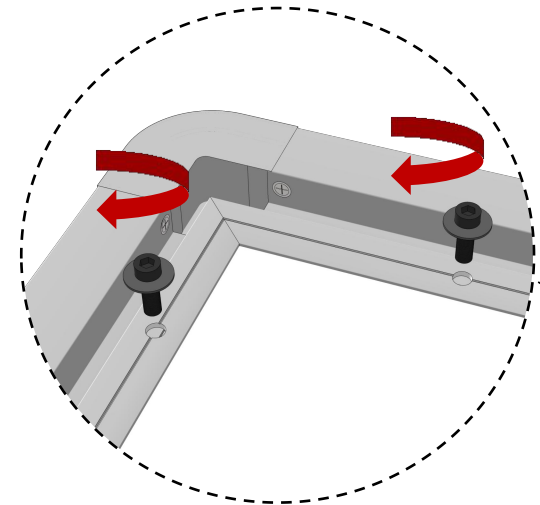
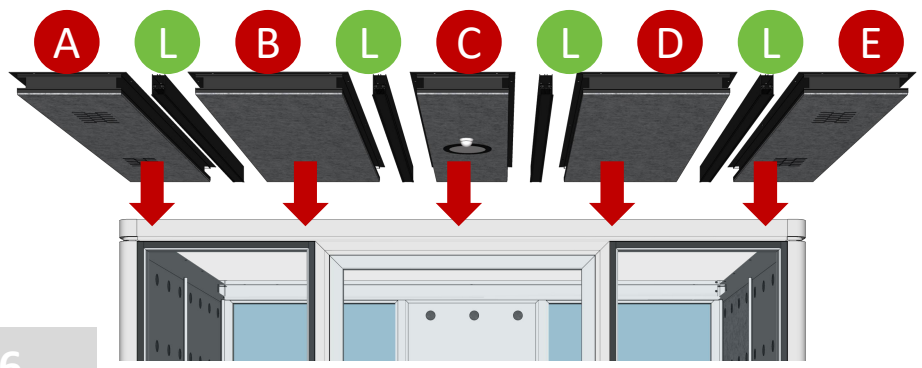
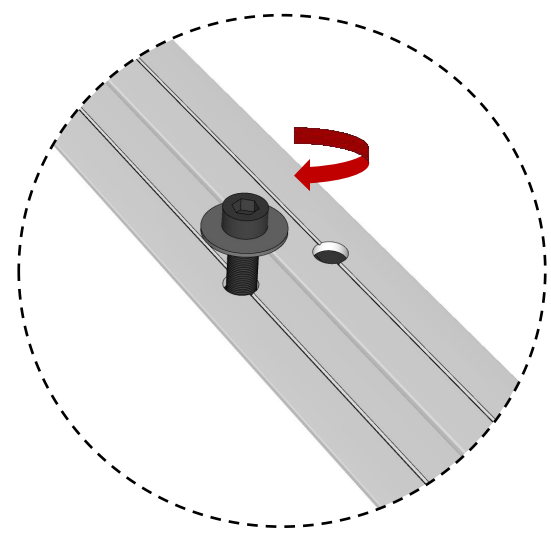
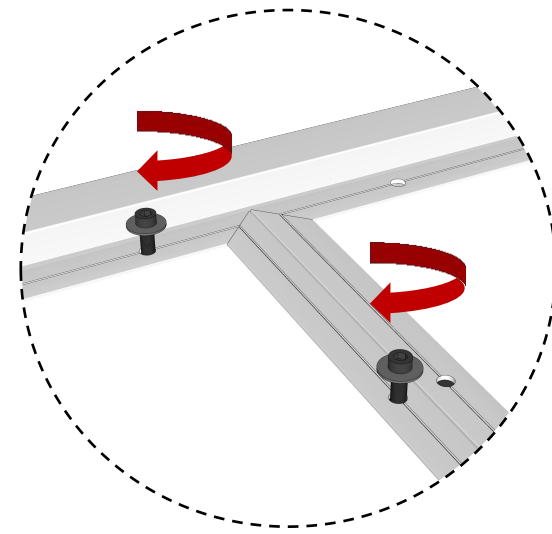
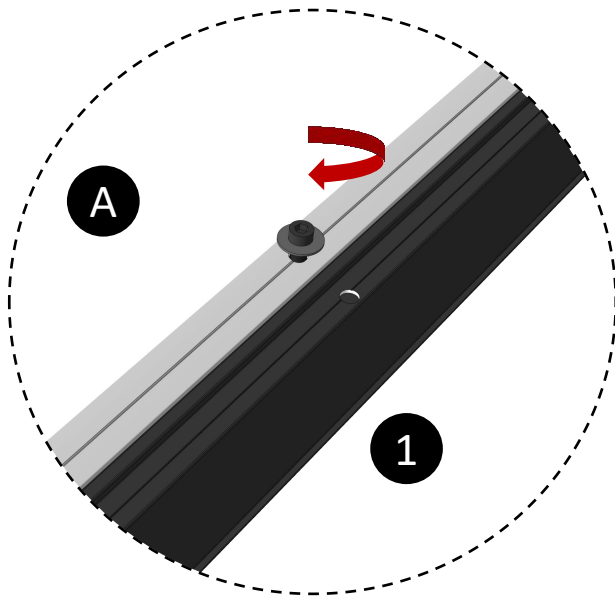
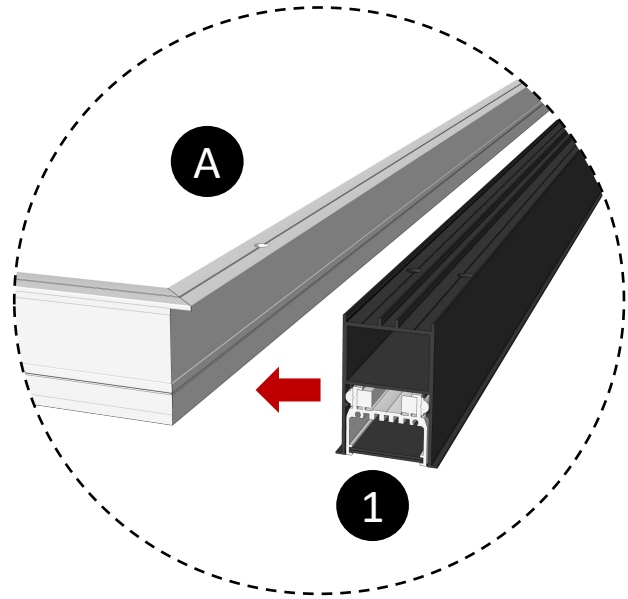

12、Wiring .

Wiring sequence:

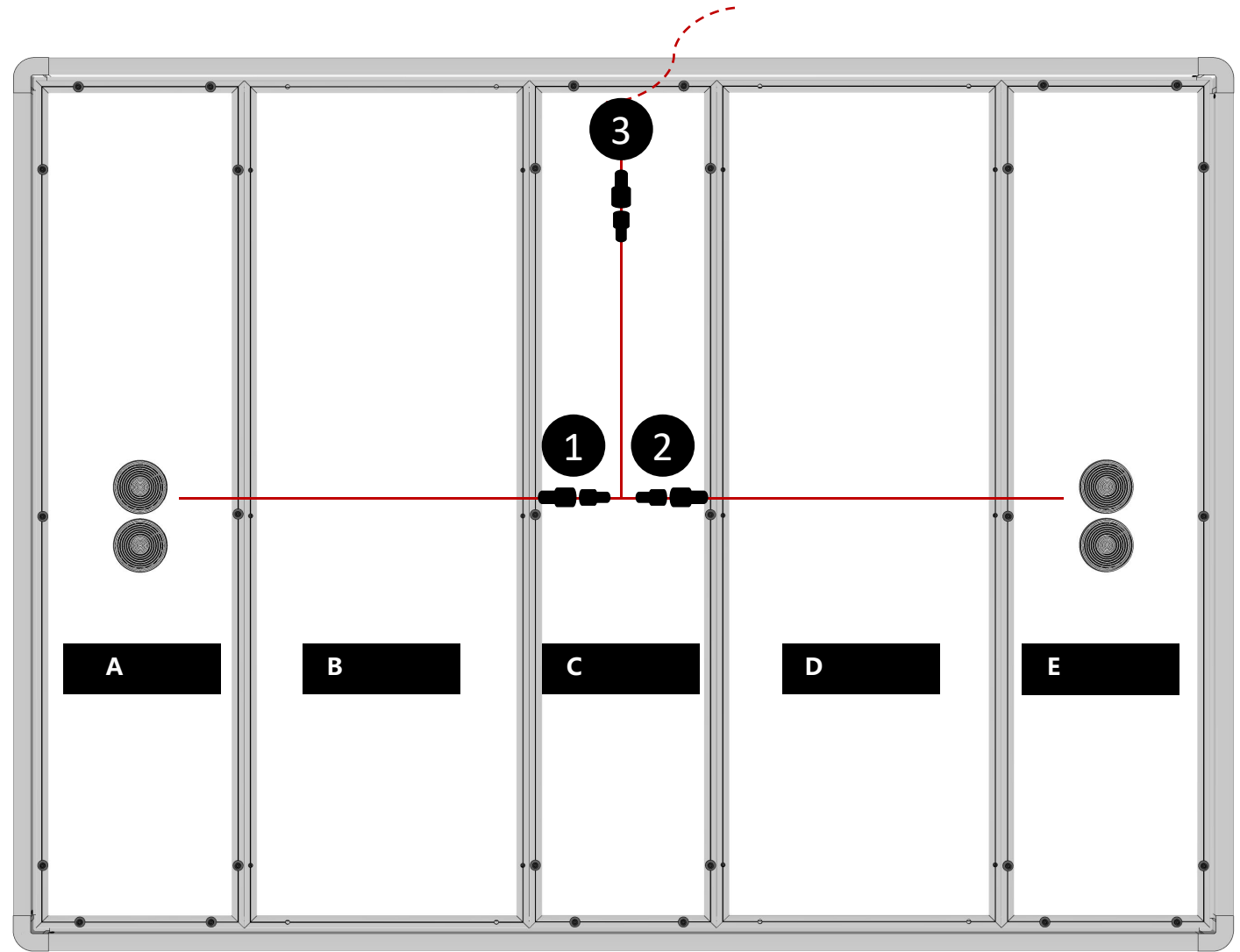
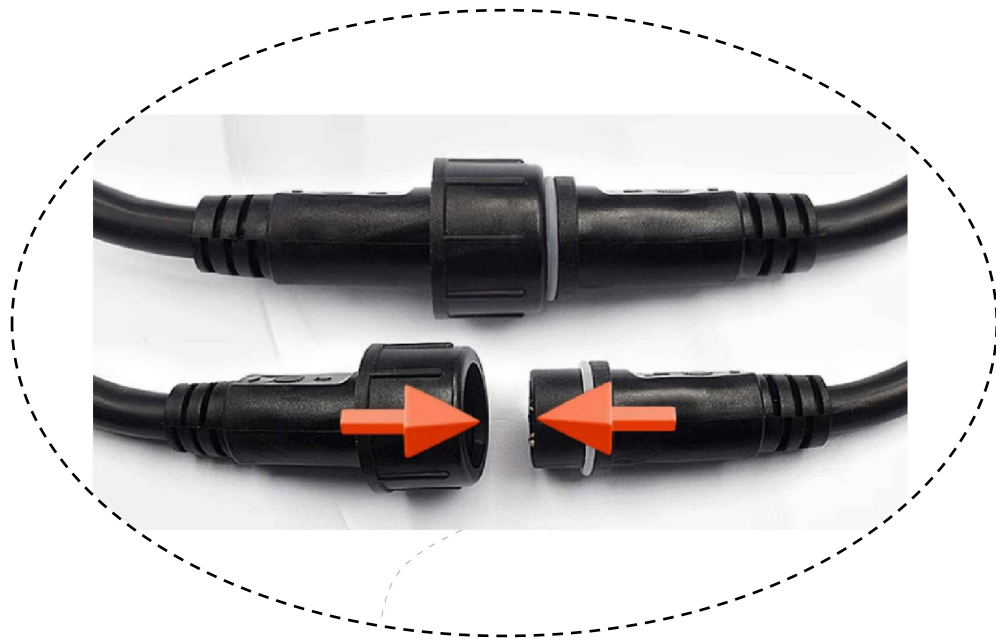

13、Install door .

One end of the hinge is already fixed on the door, you only need to screw the other end to the door frame.

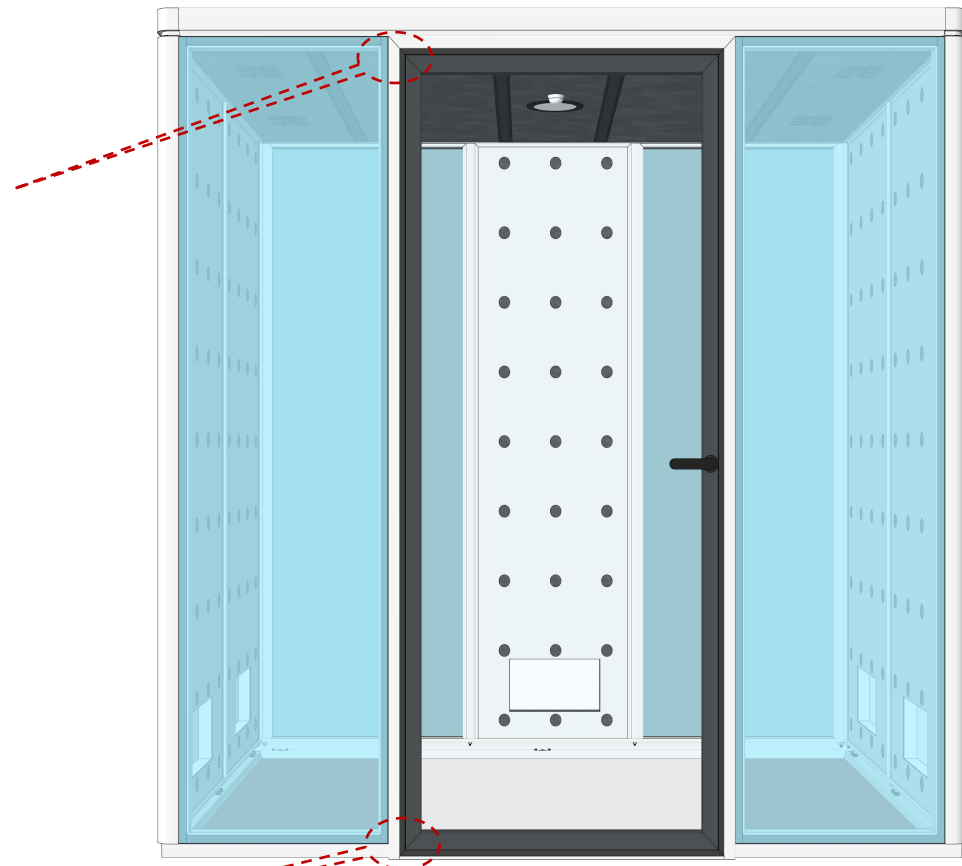
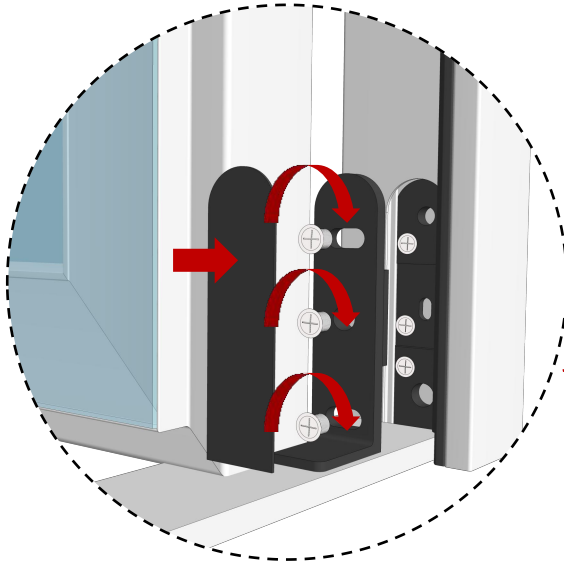
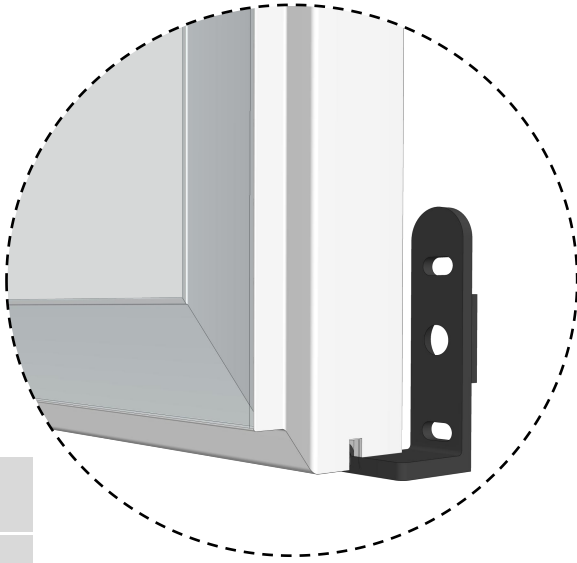
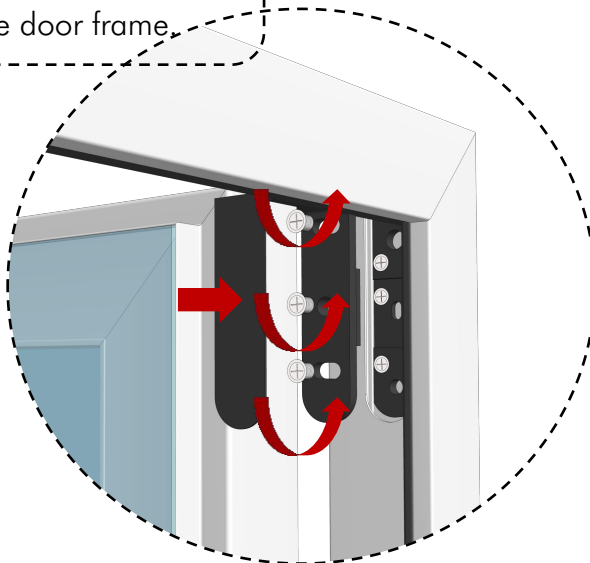
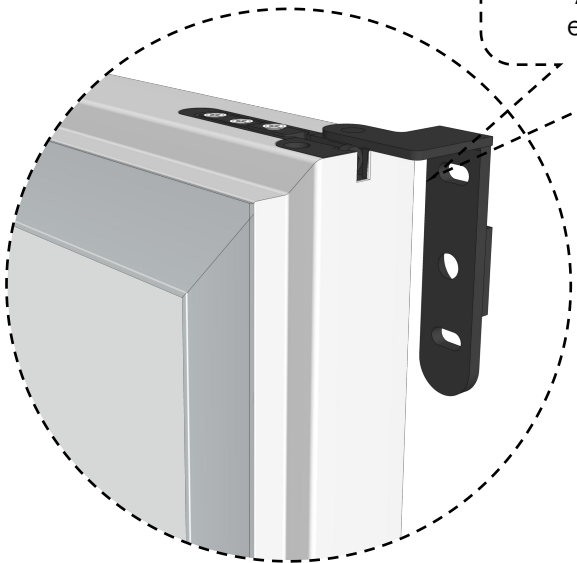

14、 Install baseboards .

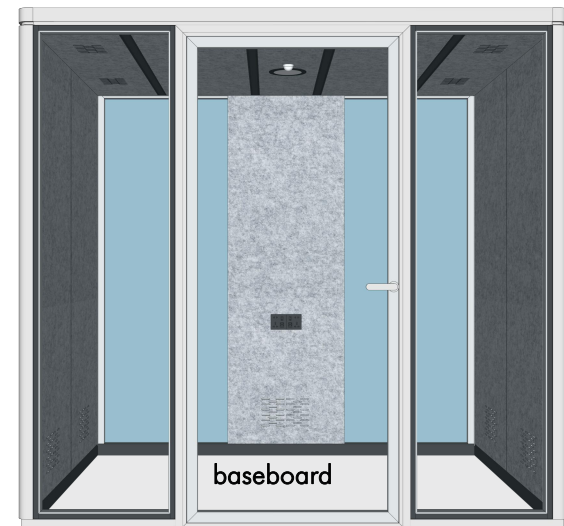
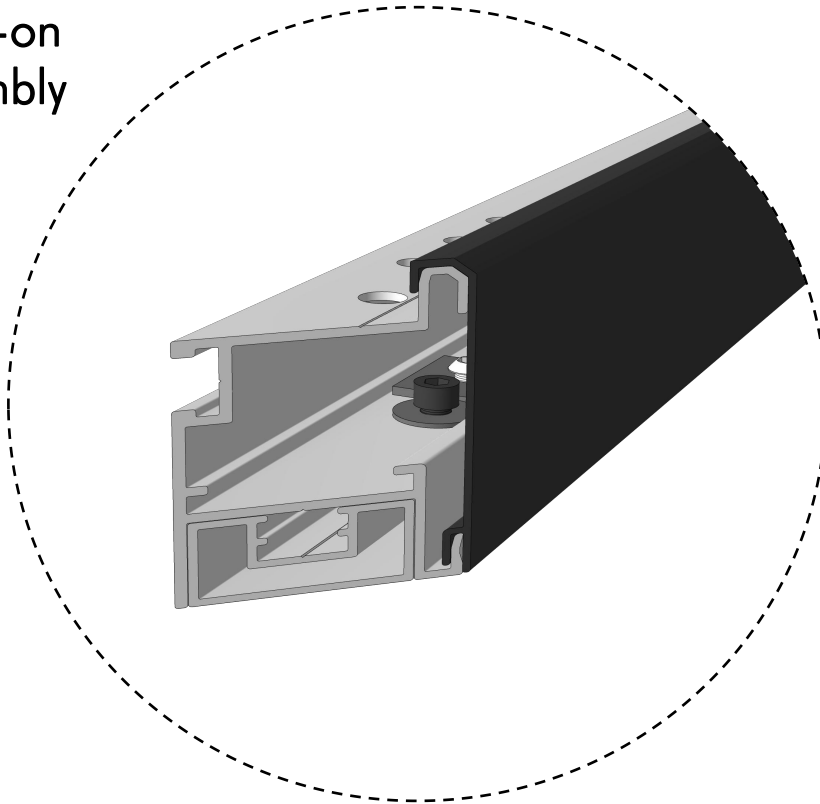
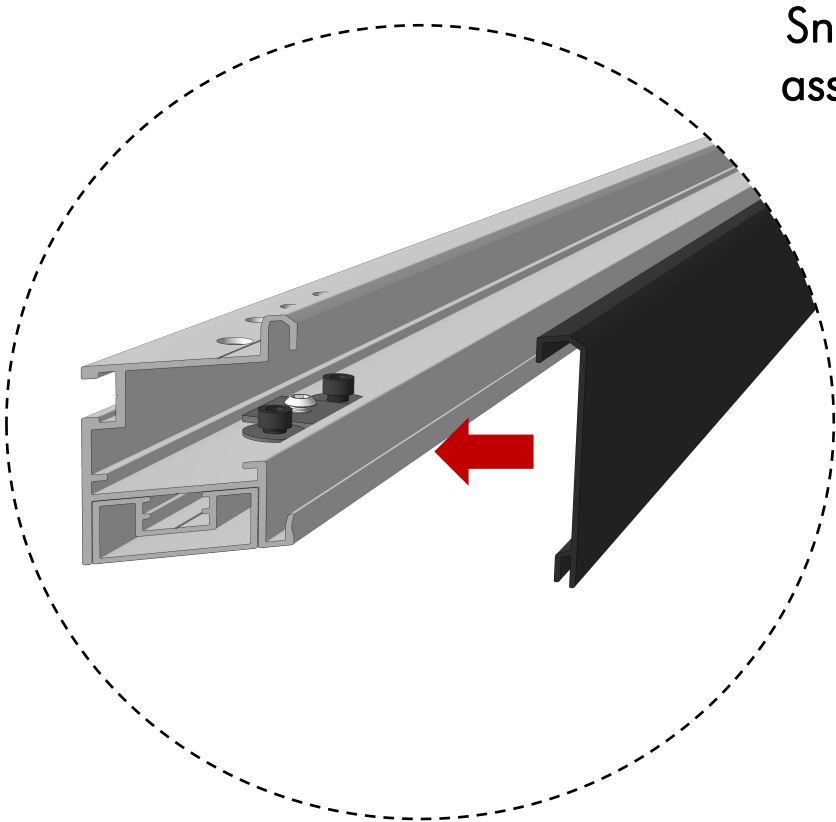

15、 Install the felt module .

