

WILLOW

2018 PRICEBOOK





- 6 Pricing
- 14 Finishes
- 14 Specifying
- 15 Terms & Conditions

Create a striking first impression with the Willow reception series, which features beautiful laminate or veneer casing, contrasting black reveals, glass transaction top and choice of curved or straight front. Design also includes satin chrome stand-offs under the glass top with three inch overhang and toekicks in black or satin finish.



INTRODUCTION
RECEPTION

WILLOW

FIRST IMPRESSIONS
**DESIGNED
TO IMPRESS**



- Black reveals (1/4" wide, 1/8" deep)
- 1 1/4" satin chrome stand-offs
- 4" toekicks in black or brushed aluminum
- 3/4" glass transaction top (clear or frosted)
- Left or right ADA options



With dozens of finish options and matching credenzas and end tables, Willow is a complete line of reception furnishings to suit any décor.



Matching credenzas and end tables



Glass transaction top and contrasting reveals



Bowfront or straight front designs

WILLOW

FRONT SHELL
(bow front)

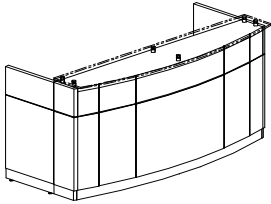

DIMENSION	LAMINATE PRODUCT #	LIST	VEN/LAM PRODUCT #	LIST	ALL VENEER PRODUCT #	LIST
30"W X 72"L X 42"H	FW-FRSH-D72L	\$15,875	FW-FRSH-D72V	\$18,155	FW-FRSH-D72AV	\$18,699
30"W X 84"L X 42"H	FW-FRSH-D84L	\$17,015	FW-FRSH-D84V	\$19,362	FW-FRSH-D84AV	\$19,943
30"W X 96"L X 42"H	FW-FRSH-D96L	\$18,261	FW-FRSH-D96V	\$20,350	FW-FRSH-D96AV	\$20,961
30"W X 108"L X 42"H *	FW-FRSH-D108L	\$18,580	FW-FRSH-D108V	\$20,867	FW-FRSH-D108AV	\$21,493
30"W X 120"L X 42"H *	FW-FRSH-D120L	\$19,265	FW-FRSH-D120V	\$21,412	FW-FRSH-D120AV	\$20,955
30"W X 144"L X 42"H *	FW-FRSH-D144L	\$23,120	FW-FRSH-D144V	\$23,959	FW-FRSH-D144AV	\$24,677

* Desks over 96" are made in two pieces **Choose clear or frosted glass

FRONT SHELL
w/ADA option - left
(bow front)

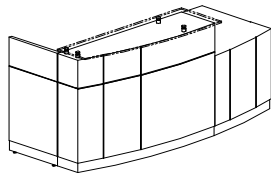

DIMENSION	LAMINATE PRODUCT #	LIST	VEN/LAM PRODUCT #	LIST	ALL VENEER PRODUCT #	LIST
30W" x 72"L X 42"H	FW-FRSH-AL72L	\$16,657	FW-FRSH-AL72V	\$18,938	FW-FRSH-AL72AV	\$19,506
30"W X 84"L X 42"H	FW-FRSH-AL84L	\$17,798	FW-FRSH-AL84V	\$20,099	FW-FRSH-AL84AV	\$20,749
30"W X 96"L X 42"H	FW-FRSH-AL96L	\$19,044	FW-FRSH-AL96V	\$21,134	FW-FRSH-AL96AV	\$21,768
30"W X 108"L X 42"H *	FW-FRSH-AL108L	\$19,362	FW-FRSH-AL108V	\$21,651	FW-FRSH-AL108AV	\$22,300
30"W X 120"L X 42"H *	FW-FRSH-AL120L	\$20,047	FW-FRSH-AL120V	\$22,196	FW-FRSH-AL120AV	\$22,863
30"W X 144"L X 42"H *	FW-FRSH-AL144L	\$23,903	FW-FRSH-AL144V	\$24,741	FW-FRSH-AL144AV	\$25,483

* Desks over 96" are made in two pieces **Choose clear or frosted glass

FRONT SHELL
w/ADA option - right
(bow front)

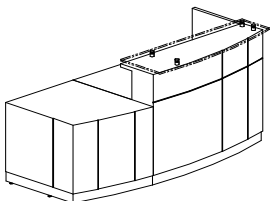

DIMENSION	LAMINATE PRODUCT #	LIST	VEN/LAM PRODUCT #	LIST	ALL VENEER PRODUCT #	LIST
30"W X 72"L X 42"H	FW-FRSH-AR72L	\$16,657	FW-FRSH-AR72V	\$18,937	FW-FRSH-AR72AV	\$19,506
30"W X 84"L X 42"H	FW-FRSH-AR84L	\$17,798	FW-FRSH-AR84V	\$20,145	FW-FRSH-AR84AV	\$20,749
30"W X 96"L X 42"H	FW-FRSH-AR96L	\$19,044	FW-FRSH-AR96V	\$21,134	FW-FRSH-AR96AV	\$21,768
30"W X 108"L X 42"H *	FW-FRSH-AR108L	\$19,362	FW-FRSH-AR108V	\$21,650	FW-FRSH-AR108AV	\$22,300
30"W X 120"L X 42"H *	FW-FRSH-AR120L	\$20,047	FW-FRSH-AR120V	\$22,196	FW-FRSH-AR120AV	\$22,861
30"W X 144"L X 42"H *	FW-FRSH-AR144L	\$23,903	FW-FRSH-AR144V	\$24,741	FW-FRSH-AR144AV	\$25,483

* Desks over 96" are made in two pieces **Choose clear or frosted glass

*Veneer/Laminate combination available in Fusion Maple, Espresso, Wild Cherry and Biltmore Cherry

Freight 20% Net / Crating fee 5% Net (minimum \$100)
based on Laminate pricing

FRONT SHELL
(straight front)

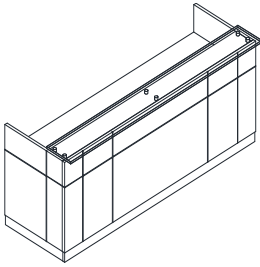

DIMENSION	LAMINATE PRODUCT #	LIST	VEN/LAM PRODUCT #	LIST	ALL VENEER PRODUCT #	LIST
30"W X 72"L X 42"H	FWS-FRSH-D72L	\$15,876	FWS-FRSH-D72V	\$18,155	FWS-FRSH-D72AV	\$18,700
30"W X 84"L X 42"H	FWS-FRSH-D84L	\$17,015	FWS-FRSH-D84V	\$19,362	FWS-FRSH-D84AV	\$19,944
30"W X 96"L X 42"H	FWS-FRSH-D96L	\$18,262	FWS-FRSH-D96V	\$20,351	FWS-FRSH-D96AV	\$20,962
30"W X 108"L X 42"H *	FWS-FRSH-D108L	\$18,580	FWS-FRSH-D108V	\$20,868	FWS-FRSH-D108AV	\$21,494
30"W X 120"L X 42"H *	FWS-FRSH-D120L	\$19,265	FWS-FRSH-D120V	\$21,413	FWS-FRSH-D120AV	\$22,056
30"W X 144"L X 42"H *	FWS-FRSH-D144L	\$21,018	FWS-FRSH-D144V	\$24,802	FWS-FRSH-D144AV	\$25,546

* Desks over 96" are made in two pieces **Choose clear or frosted glass

FRONT SHELL
w/ADA option - left
(straight front)

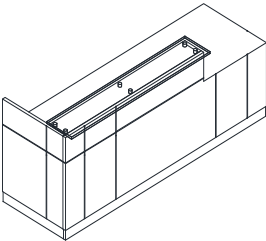

DIMENSION	LAMINATE PRODUCT #	LIST	VEN/LAM PRODUCT #	LIST	ALL VENEER PRODUCT #	LIST
30"W X 72"L X 42"H	FWS-FRSH-AL72L	\$16,658	FWS-FRSH-AL72V	\$18,938	FWS-FRSH-AL72AV	\$19,506
30"W X 84"L X 42"H	FWS-FRSH-AL84L	\$17,798	FWS-FRSH-AL84V	\$20,145	FWS-FRSH-AL84AV	\$20,750
30"W X 96"L X 42"H	FWS-FRSH-AL96L	\$19,044	FWS-FRSH-AL96V	\$21,134	FWS-FRSH-AL96AV	\$21,768
30"W X 108"L X 42"H *	FWS-FRSH-AL108L	\$19,362	FWS-FRSH-AL108V	\$21,651	FWS-FRSH-AL108AV	\$22,300
30"W X 120"L X 42"H *	FWS-FRSH-AL120L	\$20,047	FWS-FRSH-AL120V	\$22,196	FWS-FRSH-AL120AV	\$22,862
30"W X 144"L X 42"H *	FWS-FRSH-AL144L	\$21,800	FWS-FRSH-AL144V	\$25,585	FWS-FRSH-AL144AV	\$26,352

* Desks over 96" are made in two pieces **Choose clear or frosted glass

FRONT SHELL
w/ADA option - right
(straight front)

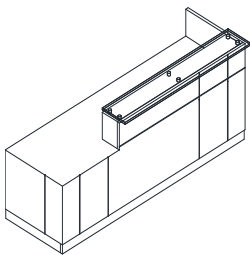

DIMENSION	LAMINATE PRODUCT #	LIST	VEN/LAM PRODUCT #	LIST	ALL VENEER PRODUCT #	LIST
30"W X 72"L X 42"H	FWS-FRSH-AR72L	\$16,658	FWS-FRSH-AR72V	\$18,938	FWS-FRSH-AR72AV	\$19,506
30"W X 84"L X 42"H	FWS-FRSH-AR84L	\$17,798	FWS-FRSH-AR84V	\$20,145	FWS-FRSH-AR84AV	\$20,750
30"W X 96"L X 42"H	FWS-FRSH-AR96L	\$19,044	FWS-FRSH-AR96V	\$21,134	FWS-FRSH-AR96AV	\$21,768
30"W X 108"L X 42"H *	FWS-FRSH-AR108L	\$19,362	FWS-FRSH-AR108V	\$21,651	FWS-FRSH-AR108AV	\$22,300
30"W X 120"L X 42"H *	FWS-FRSH-AR120L	\$20,047	FWS-FRSH-AR120V	\$22,196	FWS-FRSH-AR120AV	\$22,862
30"W X 144"L X 42"H *	FWS-FRSH-AR144L	\$21,800	FWS-FRSH-AR144V	\$25,585	FWS-FRSH-AR144AV	\$26,352

* Desks over 96" are made in two pieces **Choose clear or frosted glass

*Veneer/Laminate combination available in Fusion Maple, Espresso, Wild Cherry and Biltmore Cherry

RIGHT RETURN SHELL with transaction

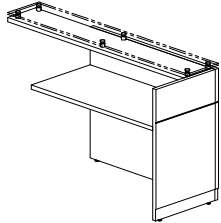

DIMENSION	LAMINATE PRODUCT #	LIST	VEN/LAM PRODUCT #	LIST	ALL VENEER PRODUCT #	LIST
24"D X 36"W X 42"H	FW-RRSH-D36L	\$8,562	FW-RRSH-D36V	\$10,103	FW-RRSH-D36AV	\$10,406
24"D X 42"W X 42"H	FW-RRSH-D42L	\$8,592	FW-RRSH-D42V	\$10,064	FW-RRSH-D42AV	\$10,366
24"D X 48"W X 42"H	FW-RRSH-D48L	\$8,821	FW-RRSH-D48V	\$10,352	FW-RRSH-D48AV	\$10,662
24"D X 60"W X 42"H	FW-RRSH-D60L	\$10,591	FW-RRSH-D60V	\$12,498	FW-RRSH-D60AV	\$12,872
24"D X 66"W X 42"H	FW-RRSH-D66L	\$11,218	FW-RRSH-D66V	\$13,237	FW-RRSH-D66AV	\$13,635

*Choose clear or frosted glass

LEFT RETURN SHELL with transaction

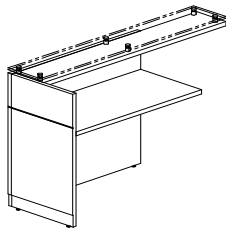

DIMENSION	LAMINATE PRODUCT #	LIST	VEN/LAM PRODUCT #	LIST	ALL VENEER PRODUCT #	LIST
24" X 36"W X 42"H	FW-LRSH-D36L	\$7,784	FW-LRSH-D36V	\$9,185	FW-LRSH-D36AV	\$9,460
24"D X 42"W X 42"H	FW-LRSH-D42L	\$8,592	FW-LRSH-D42V	\$10,064	FW-LRSH-D42AV	\$10,366
24"D X 48"W X 42"H	FW-LRSH-D48L	\$8,821	FW-LRSH-D48V	\$10,352	FW-LRSH-D48AV	\$10,662
24"D X 60"W X 42"H	FW-LRSH-D60L	\$10,591	FW-LRSH-D60V	\$12,498	FW-LRSH-D60AV	\$12,872
24"D X 66"W X 42"H	FW-LRSH-D66L	\$11,218	FW-LRSH-D66V	\$13,237	FW-LRSH-D66AV	\$13,635

*Choose clear or frosted glass

RIGHT RETURN SHELL with gallery

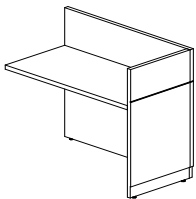

DIMENSION	LAMINATE PRODUCT #	LIST	VEN/LAM PRODUCT #	LIST	ALL VENEER PRODUCT #	LIST
24"D X 36"W X 40"H	FW-RRSH-F36L	\$4,618	FW-RRSH-F36V	\$5,450	FW-RRSH-F36AV	\$5,613
24"D X 42"W X 40"H	FW-RRSH-F42L	\$5,507	FW-RRSH-F42V	\$6,496	FW-RRSH-F42AV	\$6,692
24"D X 48"W X 40"H	FW-RRSH-F48L	\$5,703	FW-RRSH-F48V	\$6,734	FW-RRSH-F48AV	\$6,936
24"D X 60"W X 40"H	FW-RRSH-F60L	\$6,112	FW-RRSH-F60V	\$7,213	FW-RRSH-F60AV	\$7,428
24"D X 66"W X 40"H	FW-RRSH-F66L	\$6,418	FW-RRSH-F66V	\$7,573	FW-RRSH-F66AV	\$7,799

LEFT RETURN SHELL with gallery

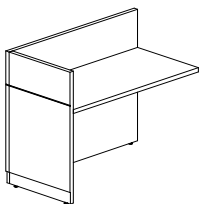

DIMENSION	LAMINATE PRODUCT #	LIST	VEN/LAM PRODUCT #	LIST	ALL VENEER PRODUCT #	LIST
24"D X 36"W 40"H	FW-LRSH-F36L	\$4,618	FW-LRSH-F36V	\$5,450	FW-LRSH-F36AV	\$5,613
24"D X 42"W X 40"H	FW-LRSH-F42L	\$5,507	FW-LRSH-F42V	\$6,496	FW-LRSH-F42AV	\$6,692
24"D X 48"W X 40"H	FW-LRSH-F48L	\$5,703	FW-LRSH-F48V	\$6,734	FW-LRSH-F48AV	\$6,936
24"D X 60"W X 40"H	FW-LRSH-F60L	\$6,112	FW-LRSH-F60V	\$7,213	FW-LRSH-F60AV	\$7,428
24"D X 66"W X 40"H	FW-LRSH-F66L	\$6,418	FW-LRSH-F66V	\$7,573	FW-LRSH-F66AV	\$7,799

*Veneer/Laminate combination available in Fusion Maple, Espresso, Wild Cherry and Biltmore Cherry

Freight 20% Net / Crating fee 5% Net (minimum \$100)
based on Laminate pricing

RIGHT RETURN SHELL

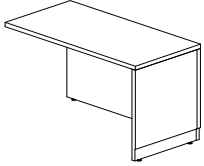

DIMENSION	LAMINATE PRODUCT #	LIST	VEN/LAM PRODUCT #	LIST	ALL VENEER PRODUCT #	LIST
24"D X 36"W X 29"H	FW-RRSH-E36L	\$3,283	FW-RRSH-E36V	\$3,874	FW-RRSH-E36AV	\$3,990
24"D X 42"W X 29"H	FW-RRSH-E42L	\$3,688	FW-RRSH-E42V	\$4,610	FW-RRSH-E42AV	\$4,748
24"D X 48"W X 29"H	FW-RRSH-E48L	\$4,135	FW-RRSH-E48V	\$5,085	FW-RRSH-E48AV	\$5,237
24"D X 60"W X 29"H	FW-RRSH-E60L	\$4,631	FW-RRSH-E60V	\$5,465	FW-RRSH-E60AV	\$5,629
24"D X 66"W X 29"H	FW-RRSH-E66L	\$4,909	FW-RRSH-E66V	\$5,793	FW-RRSH-E66AV	\$5,967

LEFT RETURN SHELL

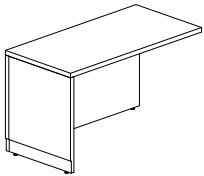

DIMENSION	LAMINATE PRODUCT #	LIST	VEN/LAM PRODUCT #	LIST	ALL VENEER PRODUCT #	LIST
24"D X 36"W X 29"H	FW-LRSH-E36L	\$3,283	FW-LRSH-E36V	\$3,874	FW-LRSH-E36AV	\$3,990
24"D X 42"W X 29"H	FW-LRSH-E42L	\$3,688	FW-LRSH-E42V	\$4,610	FW-LRSH-E42AV	\$4,748
24"D X 48"W X 29"H	FW-LRSH-E48L	\$4,135	FW-LRSH-E48V	\$5,085	FW-LRSH-E48AV	\$5,237
24"D X 60"W X 29"H	FW-LRSH-E60L	\$4,631	FW-LRSH-E60V	\$5,465	FW-LRSH-E60AV	\$5,629
24"D X 66"W X 29"H	FW-LRSH-E66L	\$4,909	FW-LRSH-E66V	\$5,793	FW-LRSH-E66AV	\$5,967

BRIDGE SHELL
with gallery

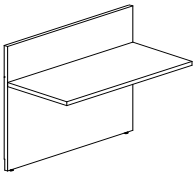

DIMENSION	LAMINATE PRODUCT #	LIST	VEN/LAM PRODUCT #	LIST	ALL VENEER PRODUCT #	LIST
24"D X 36"W X 40"H	FW-BRSH-F36L	\$3,225	FW-BRSH-F36V	\$3,806	FW-BRSH-F36AV	\$3,919
24"D X 42"W X 40"H	FW-BRSH-F42L	\$3,623	FW-BRSH-F42V	\$4,276	FW-BRSH-F42AV	\$4,404
24"D X 48"W X 40"H	FW-BRSH-F48L	\$4,072	FW-BRSH-F48V	\$4,613	FW-BRSH-F48AV	\$4,751
24"D X 60"W X 40"H	FW-BRSH-F60L	\$4,356	FW-BRSH-F60V	\$4,935	FW-BRSH-F60AV	\$5,084

BRIDGE SHELL

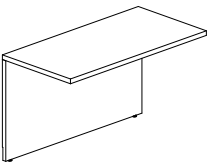

DIMENSION	LAMINATE PRODUCT #	LIST	VEN/LAM PRODUCT #	LIST	ALL VENEER PRODUCT #	LIST
24"D X 36"W X 29"H	FW-BRSH-E36L	\$2,435	FW-BRSH-E36V	\$2,873	FW-BRSH-E36AV	\$2,959
24"D X 42"W X 29"H	FW-BRSH-E42L	\$2,736	FW-BRSH-E42V	\$3,227	FW-BRSH-E42AV	\$3,325
24"D X 48"W X 29"H	FW-BRSH-E48L	\$3,073	FW-BRSH-E48V	\$3,713	FW-BRSH-E48AV	\$3,825
24"D X 60"W X 29"H	FW-BRSH-E60L	\$3,288	FW-BRSH-E60V	\$3,973	FW-BRSH-E60AV	\$4,092

*Veneer/Laminate combination available in Fusion Maple, Espresso, Wild Cherry and Biltmore Cherry

PRICING
RECEPTION

WILLOW

CREDENZA SHELL with gallery

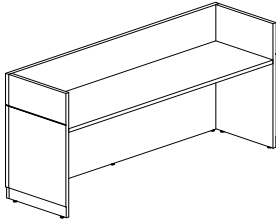

DIMENSION	LAMINATE PRODUCT #	LIST	VEN/LAM PRODUCT #	LIST	ALL VENEER PRODUCT #	LIST
24"D X 72"W X 40"H	FW-CRSH-F72L	\$7,986	FW-CRSH-F72V	\$8,377	FW-CRSH-F72AV	\$8,628
24"D X 84"W X 40"H	FW-CRSH-F84L	\$9,185	FW-CRSH-F84V	\$9,809	FW-CRSH-F84AV	\$10,104
24"D X 96"W X 40"H	FW-CRSH-F96L	\$10,384	FW-CRSH-F96V	\$11,242	FW-CRSH-F96AV	\$11,580
24"D X 108"W X 40"H	FW-CRSH-F108L	\$15,095	FW-CRSH-F108V	\$15,549	FW-CRSH-F108AV	\$12,792
24"D X 120"W X 40"H	FW-CRSH-F120L	\$13,025	FW-CRSH-F120V	\$15,370	FW-CRSH-F120AV	\$15,831

CREDENZA SHELL

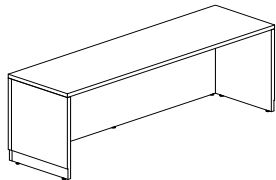

DIMENSION	LAMINATE PRODUCT #	LIST	VEN/LAM PRODUCT #	LIST	ALL VENEER PRODUCT #	LIST
24"D X 72"W X 29"H	FW-CRSH-E72L	\$4,681	FW-CRSH-E72V	\$5,829	FW-CRSH-E72AV	\$6,005
24"D X 84"W X 29"H	FW-CRSH-E84L	\$5,065	FW-CRSH-E84V	\$6,304	FW-CRSH-E84AV	\$6,494
24"D X 96"W X 29"H	FW-CRSH-E96L	\$5,448	FW-CRSH-E96V	\$6,779	FW-CRSH-E96AV	\$6,982
24"D X 108"W X 29"H	FW-CRSH-E108L	\$7,921	FW-CRSH-E108V	\$8,158	FW-CRSH-E108AV	\$6,713
24"D X 120"W X 29"H	FW-CRSH-E120L	\$6,834	FW-CRSH-E120V	\$8,065	FW-CRSH-E120AV	\$8,307

STORAGE CREDENZA

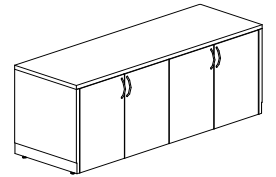

DIMENSION	LAMINATE PRODUCT #	LIST	VEN/LAM PRODUCT #	LIST	ALL VENEER PRODUCT #	LIST
24"D X 36"W X 29"H	FW-C-E36L	\$3,296	FW-C-E36V	\$3,889	FW-C-E36AV	\$4,006
24"D X 48"W X 29"H	FW-C-E48L	\$3,691	FW-C-E48V	\$4,356	FW-C-E48AV	\$4,486
24"D X 60"W X 29"H	FW-C-E60L	\$4,134	FW-C-E60V	\$4,878	FW-C-E60AV	\$5,024
24"D X 72"W X 29"H	FW-C-E72L	\$4,394	FW-C-E72V	\$6,680	FW-C-E72AV	\$6,881
24"D X 96"W X 29"H	FW-C-E96L	\$6,826	FW-C-E96V	\$8,056	FW-C-E96AV	\$8,297

BUFFET

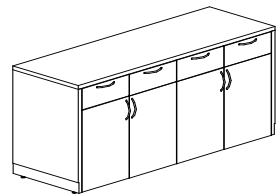

DIMENSION	LAMINATE PRODUCT #	LIST	VEN/LAM PRODUCT #	LIST	ALL VENEER PRODUCT #	LIST
24"D X 36"W X 36"H	FW-B-E36L	\$4,598	FW-B-E36V	\$5,425	FW-B-E36AV	\$5,588
24"D X 48"W X 36"H	FW-B-E48L	\$5,149	FW-B-E48V	\$6,076	FW-B-E48AV	\$6,259
24"D X 60"W X 36"H	FW-B-E60L	\$5,767	FW-B-E60V	\$6,805	FW-B-E60AV	\$7,009
24"D X 72"W X 36"H	FW-B-E72L	\$6,703	FW-B-E72V	\$8,108	FW-B-E72AV	\$8,352
24"D X 96"W X 36"H	FW-B-E96L	\$9,463	FW-B-E96V	\$11,165	FW-B-E96AV	\$11,499

*Veneer/Laminate combination available in Fusion Maple, Espresso, Wild Cherry and Biltmore Cherry

Freight 20% Net / Crating fee 5% Net (minimum \$100)
based on Laminate pricing

BOX-BOX-FILE
MOBILE PEDESTAL
(includes lock)



DIMENSION	LAMINATE PRODUCT #	LIST	ALL VENEER PRODUCT #	LIST
22"D X 16"W X 27"H	BBFM-L	\$1,753	BBFM-V	\$2,667

FILE-FILE MOBILE
PEDESTAL
(includes lock)



DIMENSION	LAMINATE PRODUCT #	LIST	ALL VENEER PRODUCT #	LIST
22"D X 16"W X 27"H	FFM-L	\$1,753	FFM-V	\$2,667

BOX-BOX-FILE PEDESTAL
(includes lock)

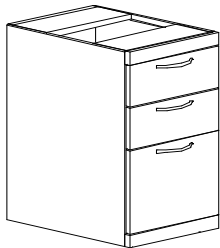

DIMENSION	LAMINATE PRODUCT #	LIST	ALL VENEER PRODUCT #	LIST
22"D X 16"W X 27"H	BBF-L	\$1,232	BBF-V	\$2,032

FILE-FILE PEDESTAL
(includes lock)

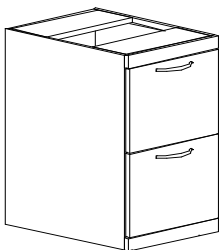

DIMENSION	LAMINATE PRODUCT #	LIST	ALL VENEER PRODUCT #	LIST
22"D X 16"W X 27"H	FF-L	\$1,232	FF-V	\$2,032

*Veneer/Laminate combination available in Fusion Maple, Espresso, Wild Cherry and Biltmore Cherry

STORAGE PEDESTAL
hinged door left

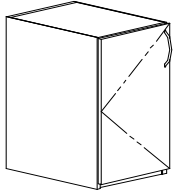

DIMENSION	LAMINATE PRODUCT #	LIST	ALL VENEER PRODUCT #	LIST
22"D X 16"W X 27"H	FW-LD-L	\$1,105	FW-LD-V	\$1,918

STORAGE PEDESTAL
hinged door right

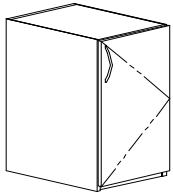

DIMENSION	LAMINATE PRODUCT #	LIST	ALL VENEER PRODUCT #	LIST
22"D X 16"W X 27"H	FW-RD-L	\$1,215	FW-RD-V	\$2,109

STORAGE PEDESTAL
hinged door left w/drawer

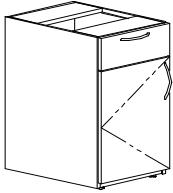

DIMENSION	LAMINATE PRODUCT #	LIST	ALL VENEER PRODUCT #	LIST
22"D X 16"W X 27"H	FW-LBD-L	\$1,219	FW-LBD-V	\$2,045

STORAGE PEDESTAL
hinged door right w/drawer

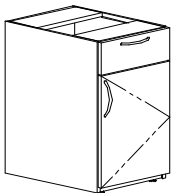

DIMENSION	LAMINATE PRODUCT #	LIST	ALL VENEER PRODUCT #	LIST
22"D X 16"W X 27"H	FW-RBD-L	\$1,341	FW-RBD-V	\$2,249

LATERAL-FILE PEDESTAL
(includes lock)

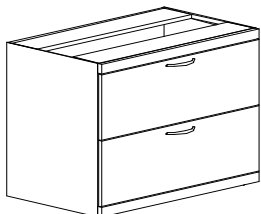

DIMENSION	LAMINATE PRODUCT #	LIST	ALL VENEER PRODUCT #	LIST
22"D X 36"W X 27"H	LF-36-L	\$2,654	LF-36-V	\$3,493

*Veneer/Laminate combination available in Fusion Maple, Espresso, Wild Cherry and Biltmore Cherry

Freight 20% Net / Crating fee 5% Net (minimum \$100)
based on Laminate pricing

DRUM TABLE

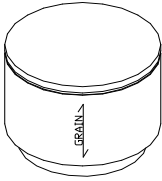

DIMENSION	LAMINATE PRODUCT #	LIST	VEN/LAM PRODUCT #	LIST	ALL VENEER PRODUCT #	LIST
Ø18" x 16"H	FW-LT-D1816L	\$1,579	FW-LT-D1816V	\$2,305	FW-LT-D1816AV	\$2,375
Ø18" X 20"H	FW-LT-D1820L	\$1,657	FW-LT-D1820V	\$2,420	FW-LT-D1820AV	\$2,494
Ø24" X 16"H	FW-LT-D2416L	\$1,746	FW-LT-D2416V	\$2,515	FW-LT-D2416AV	\$2,590
Ø24" X 20"H	FW-LT-D2420L	\$1,833	FW-LT-D2420V	\$2,640	FW-LT-D2420AV	\$2,719

CUBE TABLE

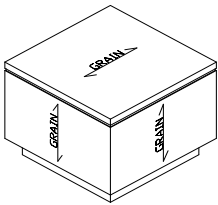

DIMENSION	LAMINATE PRODUCT #	LIST	VEN/LAM PRODUCT #	LIST	ALL VENEER PRODUCT #	LIST
18" X 18" 16"H	FW-LT-C1816L	\$1,187	FW-LT-C1816V	\$1,942	FW-LT-C1816AV	\$2,001
18" X 18" X 20"H	FW-LT-C1820L	\$1,246	FW-LT-C1820V	\$2,038	FW-LT-C1820AV	\$2,100
24" X 24" X 16"H	FW-LT-C2416L	\$1,355	FW-LT-C2416V	\$2,123	FW-LT-C2416AV	\$2,188
24" X 24" X 20"H	FW-LT-C2420L	\$1,422	FW-LT-C2420V	\$2,230	FW-LT-C2420AV	\$2,297

RECTANGULAR TABLE

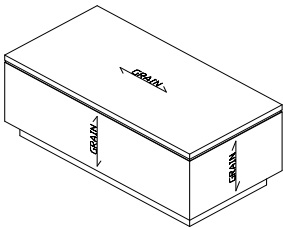

DIMENSION	LAMINATE PRODUCT #	LIST	VEN/LAM PRODUCT #	LIST	ALL VENEER PRODUCT #	LIST
18" X 36" X 16"H	FW-LT-R1836L	\$1,634	FW-LT-R1836V	\$2,598	FW-LT-R1836AV	\$2,677
24" X 48" X 16"H	FW-LT-R2448L	\$1,936	FW-LT-R2448V	\$2,906	FW-LT-R2448AV	\$2,992

ELLIPTICAL TABLE

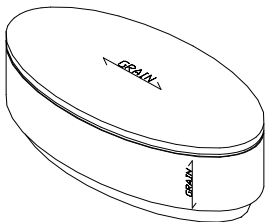

DIMENSION	LAMINATE PRODUCT #	LIST	VEN/LAM PRODUCT #	LIST	ALL VENEER PRODUCT #	LIST
24" X 48" X 16"H	FW-LT-E2448L	\$2,403	FW-LT-E2448V	\$3,562	FW-LT-E2448AV	\$3,670

*Veneer/Laminate combination available in Fusion Maple, Espresso, Wild Cherry and Biltmore Cherry

The product #s all end with a letter code of **L**, **V** or **AV** that specifies the finish category. When ordering, add the number of your finish selections to the end of the product #, as shown below.

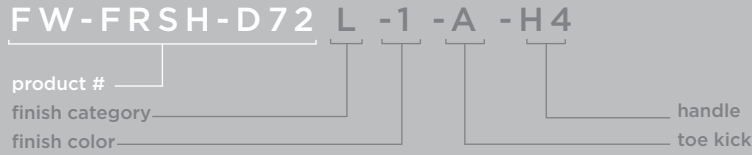

FINISH OPTIONS

LAMINATES (L)

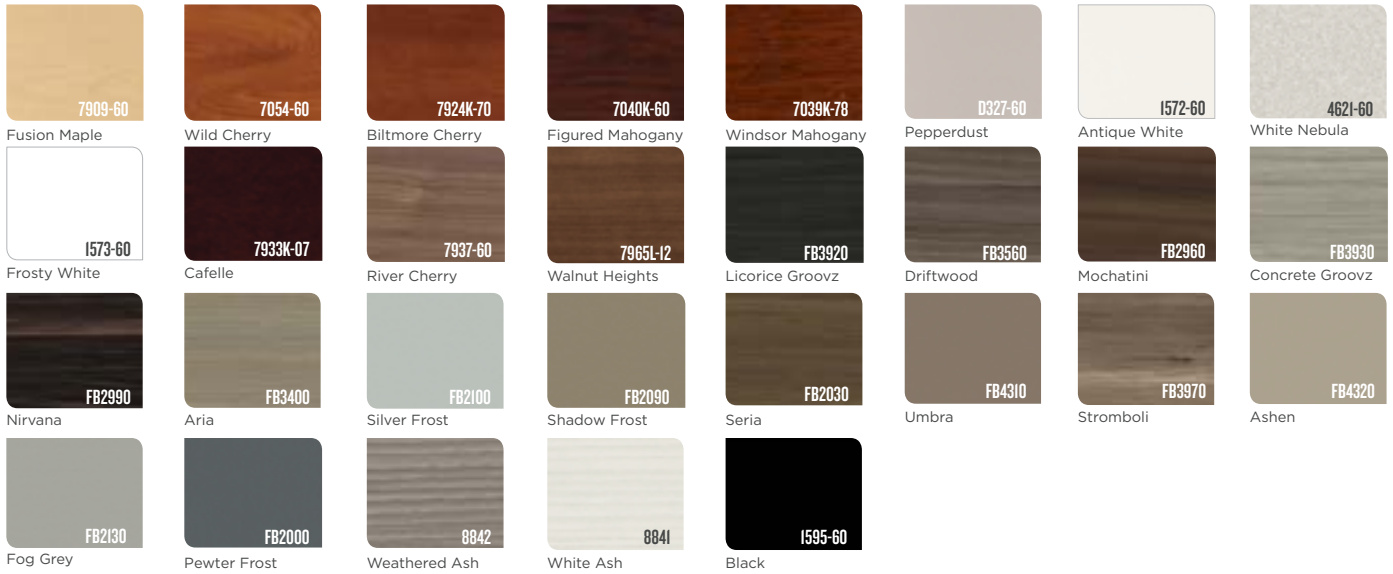

WOOD VENEERS (AV)

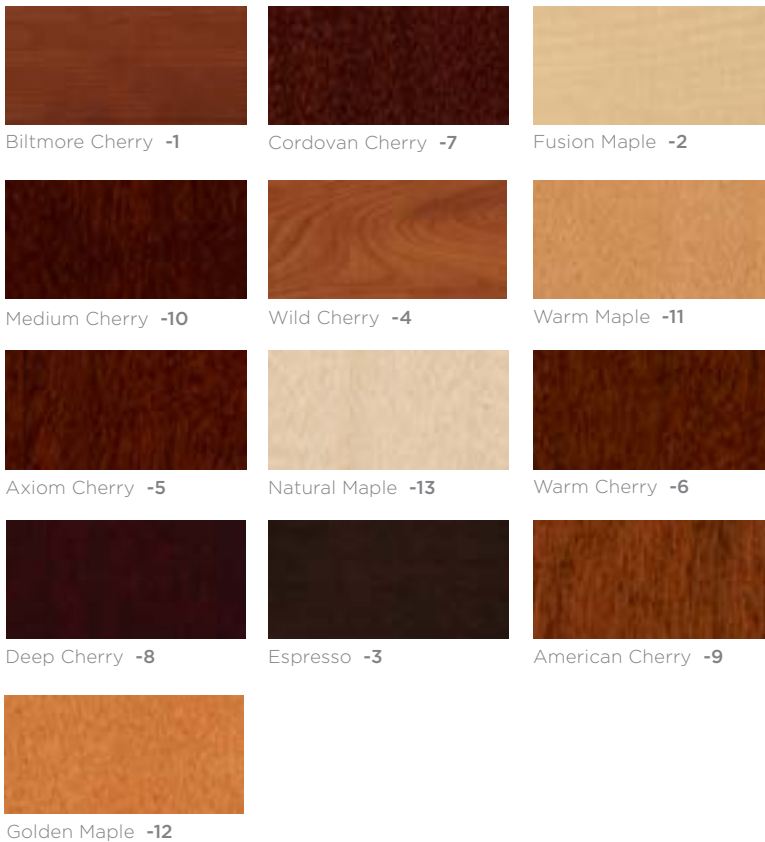

HANDLE OPTIONS

Each handle style is available in either Black or Satin finish - specify finish on order.



TOE KICKS



REVEALS



PRICES

All prices are F.O.B. point. We reserve the right to change prices without prior notice.

TERMS

Net 30 days from date of invoice with established terms. Invoices are delinquent if not paid (30) days from date of invoice. In the event timely payment is not made, interest will be charged at the rate of 1.5% per month on delinquent accounts. Buyers will also be liable for normal collection costs and attorney fees.

ORDERS

Orders are only accepted by issuance of a P.O., and are subject to the terms set forth herein and on our order acknowledgment. It is the responsibility of the buyer to review our acknowledgment for accuracy, and to notify Friant within 48 hours from the acknowledgment date of any discrepancies. Please send all purchase orders to orders@friant.com or fax to (510) (510) 535-6895. If you have any questions, please contact Customer Service at (510) 535-5113.

ORDER CHANGES AND CANCELLATIONS

Our order confirmation is final and binding. Any order change or cancellation is subject to our ability to conform. Such requests are to be made in writing to our office and may be subject to a fee.

RETURNS

No merchandise may be returned without our written consent and shipping instructions, and are subject to a 35% restocking fee. Unauthorized returns will not be accepted and will be returned freight collect. All packages are labeled with contents, and it is the customer's responsibility to check box labels against the packing list for accuracy before opening. If correctly labeled and undamaged product is removed from its original packaging, Friant will not accept its return.

CLAIMS

We are not responsible for damage suffered in transit. Merchandise should be inspected for possible freight damage upon delivery. Claims for damage or shortages should be filed by the consignee with the carrier within 5 days of delivery. You are also protected for "concealed damage" if you file claim with the carrier within 5 days of delivery. All claims against Friant for defects, errors or shortages must be made by Buyer in writing within 10 days after delivery. Failure to make such a claim shall constitute full acceptance. All claims must be pre-approved and with a P.O. issued to Friant before reimbursement and/or reinstallation will be granted.

SHIPPING

Freight for Willow is 20% of net to all areas plus a crating fee of 5% net (minimum \$100). Willow has

\$100 surcharge for all orders under \$1500 net. Friant generally palletizes, boxes and/or shrink wraps its products. If Buyer requests additional packaging or special shipping, extra charges will apply. Buyer obtains title to products and assumes the risk of damage and or loss of product upon shipment from Friant's plant.

PARTIAL SHIPMENTS

We will make every attempt to ship orders complete and on schedule. However, we reserve the right to make partial shipments as merchandise is ready. Invoices covering these partial shipments are to be paid as they become due.

SHIPPING AND PREPAID FREIGHT

Unless otherwise instructed, we reserve the option to ship by what is, in our opinion, the best possible way. Upon request, we will prepay and add freight for accounts with established credit. Please see our web site for estimated freight times.

DELIVERY

We are not liable for delay or failure of delivery due to strikes and/or differences with workmen, war, riot, fire, compliance with government regulations, acts of nature, failure or delays of sources of supply, or any other causes beyond our control.

CONSTRUCTION - SPECIFICATIONS

All items are produced to price list specifications unless otherwise advised. All dimensions shown are approximate. Manufacturer reserves the right to make modifications and/or improvements without prior notice.

COMPLIANCE WITH LAW

Purchaser is solely responsible for compliance with all applicable Federal, State and Local laws, ordinances, regulations, rules and standards relating to the installation, maintenance, use and operation of products.

PRODUCT WARRANTY - 3 YEARS

This warranty is given to the initial purchaser and is valid from the date of purchase, for 3 years. This warranty covers defects in material and craftsmanship found during normal usage of the product during the warranty period. If the product is defective, and if written notice of the defect is given to Friant & Associates within the applicable warranty period, Friant & Associates, at its option, will either repair or replace the defective product with a comparable component or product. This warranty applies to all products except as noted below. High wear parts, such as fabrics, other covering material/ finishes, foam, glides, etc. are warranted for One (1) Year. This warranty does not apply to damage caused by a carrier, alteration to the

product not expressly authorized by Friant & Associates, nor to product considered to be of a consumable nature such as bulbs, light

WARRANTY EXCEPTIONS:

- Natural variations in wood grain, figure or the presence of character marks
- Matching of colors, grains, textures
- Changes in surface finishes due to aging or exposure to light
- Damage, marking or staining of surfaces due to contact with rubber or similar compounds
- Damage from sharp objects or imprinting from writing instruments, computer equipment or prolonged exposure to fluids or sun
- Checking or de-laminating due to changes in temperature or improper care or storage
- Damage caused by misuse or improper care

Friant & Associates does not guarantee the matching of colors, grain or texture, except to within commercially acceptable standards.

A product will not be considered defective, and Friant & Associates will not be obligated to replace it, if it is not installed in a proper manner (i.e., product not leveled, not secured properly, etc.).

Except as noted above, Friant & Associates makes no express or implied warranties as to any product, and in particular makes no warranty of fitness for any particular use. At Friant & Associates' option, product repair and/or replacement are the customer's exclusive remedy for any and all product defects.

Friant & Associates shall not be liable for consequential, economic or incidental damages arising from any product defect.

CARE AND MAINTENANCE

Friant & Associates' finish provides excellent stain and mar resistance. Care should be exercised when cleaning. The following precautions will help keep the product looking new:

- Dust all surfaces on a regular basis with a soft damp cloth. Do not use spray polishes - especially those containing silicone.
- Lift all objects from the surface when moving - never drag objects across the surface.
- Metal objects should be kept from contacting the surface.

CALIFORNIA PROP 65 WARNING:

Products in this catalog may contain a chemical known to the state of California to cause cancer, or birth defects or other reproductive harm.



CARB COMPLIANT

Willow laminates meet or exceed California (CARB) air quality emission standards — the most stringent in the country — for composite wood products.

FRIANT

**OFFICE FURNITURE
MADE SMARTER**
**OUR MISSION IS
TO MAKE HIGH-END
DESIGNER WORKSPACES
MORE ACCESSIBLE & AFFORDABLE
BY BRINGING MODERN
BUSINESS
INNOVATION
TO DESIGN**

HERE'S TO PAYING LESS FOR A BEAUTIFUL WORK ENVIRONMENT

4901 East 12th St / Oakland / California 94601 / T:510.535.5113 / F: 510.535.5237 / friant.com

