

# Droid User Guide

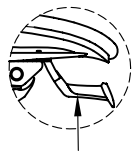

The seat can be adjusted forward and back by pulling handle up.

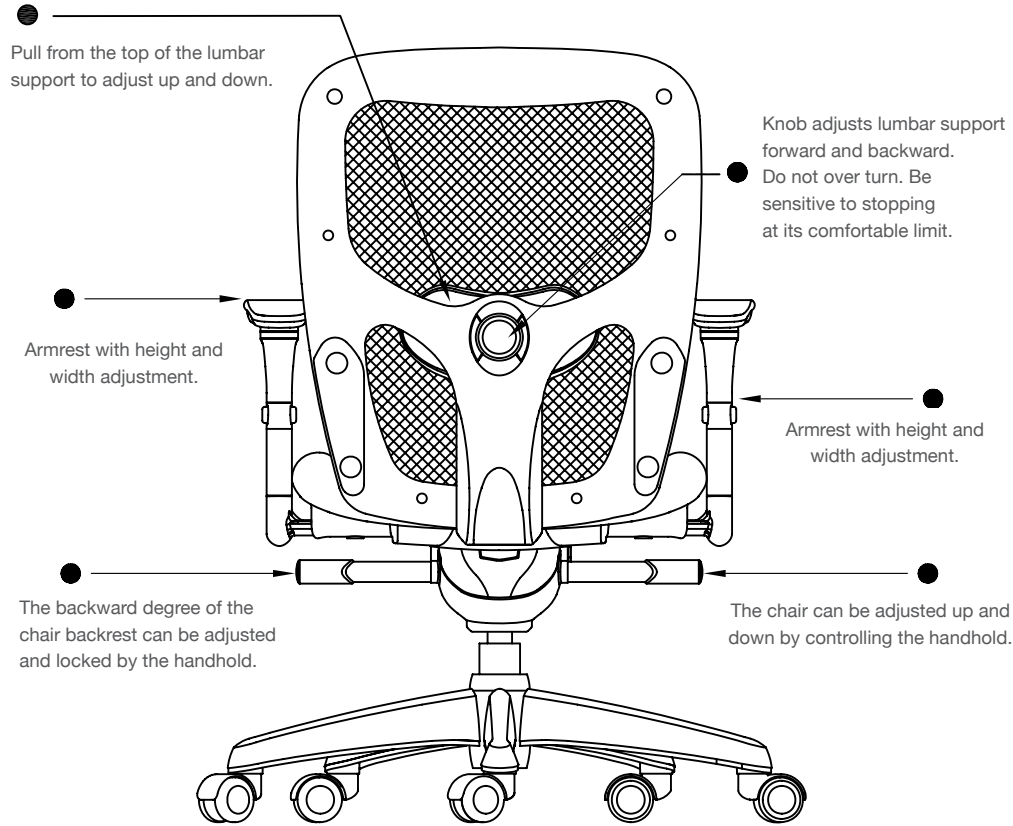
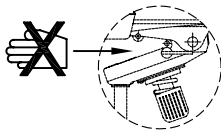

Adjustable tension knob for back tilt to fit different people's weights.

Do not put your hand in when turning to avoid getting hurt.



Droid

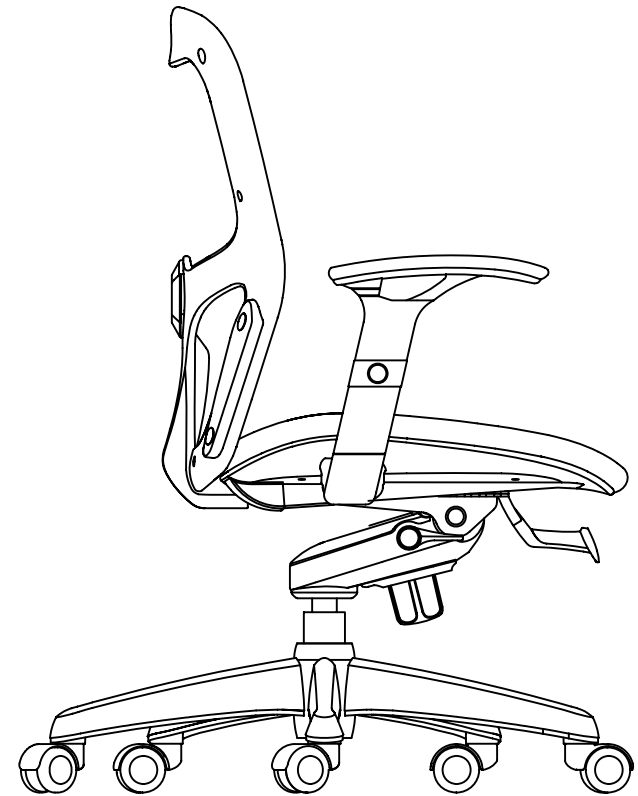

## ASSEMBLY INSTRUCTIONS

- ① Insert the caster (I) into the hole at the bottom of five star base (H).
- ② Insert the thick part of gas lift (G) into the center hole of five star base (H).
- ③ Connect the handle (C) into sliding Mechanism (E), then fix up with screw (d).
- ④ Attach the backrest (A) to the metal part of the mechanism (D), the metal part of the backrest (A) should be above the metal part of the mechanism (D) . Before tightening screws ,add the spring washer (K) and flat washer (J) as the draft, then tighten with screw (a) from the bottom up. And the mid-line of the metal part of the backrest (A) should be aimed at mid-line of metal part of mechanism (D) as holes showed in the draft(1).
- ⑤ Attach the wholly assembled mechanism(D) and backrest (A) to the thin part of the gas lift (G).
- ⑥ Move the slider mechanism (E) to the last gear,assemble it onto the seat cushion (F) with screw b . then move the slider back to the first gear.(see the drawing left)
- ⑦ Attach the seat cushion (F)with slide mechanism (C) to the mechanism (D), then fasten with screw (c) from the underside.
- ⑧ Finally insert armrest (B) into square holes at both side of the seat cushion (F). Before inserting the knob (L), add flat washer (F) in the knob (L). Then put width adjustable knob (J) into holes at the bottom of seat cushion (L) and fix it.
- ⑨ Make sure all the screws are fully tightened and assemble the chair in the right way before using the chair.

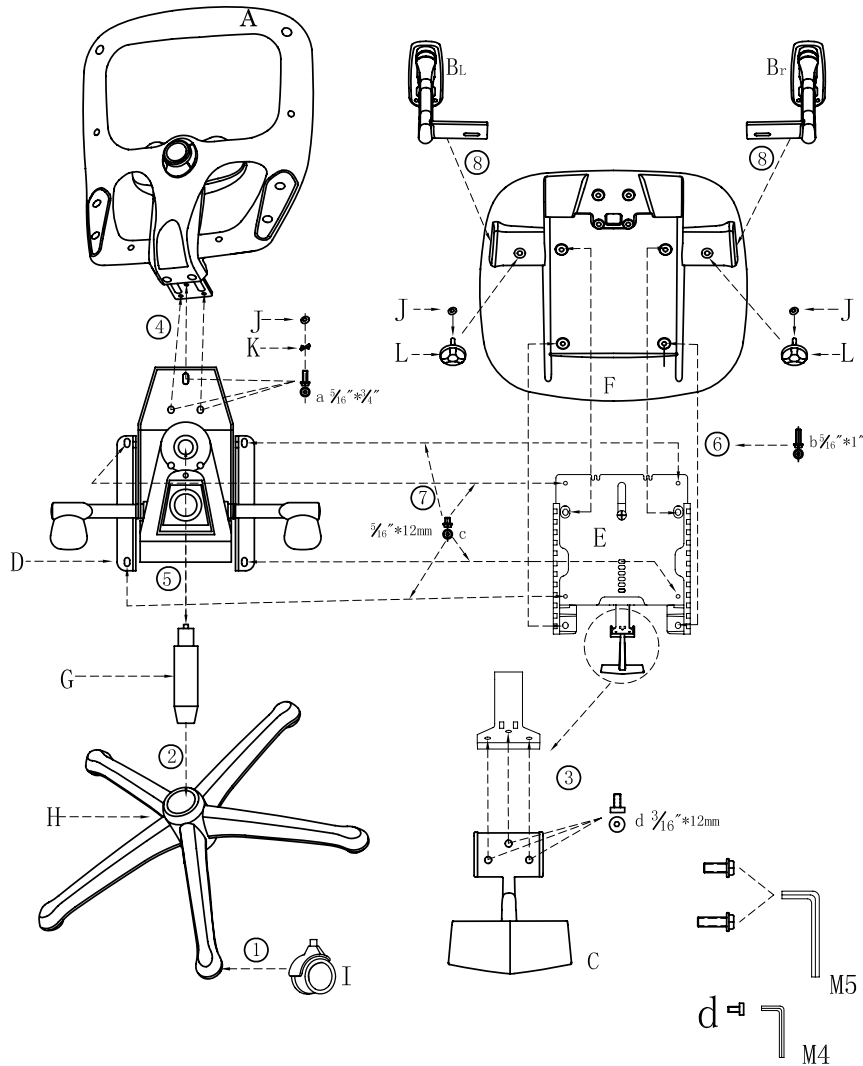

No.	Parts	Qty
A	Backrest	1
B	Armrest	L\R
C	Sliding handle	1
D	Mechanism	1
E	Slide mechanism	1
F	Seat cushion	1
G	Gas lift	1
H	Base	5
I	Caster	5
J	Flat washer	3
K	Spring washer	2
L	Width adjustable knob	1
M5	Wrench	1
M4	Wrench	1

### Screws list:

No.	Specification	Qty	Spare parts
a	Screw $\frac{5}{16}$ " $\times$ $\frac{3}{4}$ "	3	1
b	Screw $\frac{5}{16}$ " $\times$ 1"	4	1
c	Screw $\frac{5}{16}$ " $\times$ 12mm	4	1
d	Screw $\frac{3}{16}$ " $\times$ 15mm	3	1

### ATTENTION:

- 1: Carefully check all the parts according to the instruction before assembling.
- 2: Please assemble carefully avoid to scraich the surface,especially the powder coated parts.

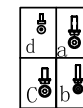

draft (2)

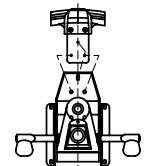

draft (1)